



HUNAN HANDA
VALVE CO., LTD
湖南翰达阀门有限公司



· 致力于为流体控制产业提供性能可靠、品质卓越的阀门及相关流体控制产品和服务。

· Dedicated to providing valves of reliable performance and excellent quality and related fluid control products and services for the fluid control industry.



湖南翰达
阀门有限公司

地址
湖南省澧县经济开发区
创新创业园10号楼1-2层

电话：0736-3249799
网址：www.handavalve.com
邮箱：info@handavalve.com

HUNAN HANDA
VALVE CO., LTD

Add:
1st-2nd Floor, No. 10 Pioneering Innovation Building,
economic development Zone, LI County, Hunan Province

Tel: +86 736-3249799
www.handavalve.com
info@handavalve.com



www.handavalve.com



服务热线 Service Hotline
1360-6072-028



扫一扫关注了解更多



个人咨询售后服务号

High Performance
Ball Valves
高性能球阀

International Quality, Precise Control

HUNAN HANDA VALVE CO., LTD. is a professional high-tech manufacturer of valves and automatic control equipment integrating research, development, design, production, sale and service. With a land area of 26,800m², a construction area of 40000m², and 286 employees including 58 senior and intermediate technicians, our company has CAD and CAM research, development, design and manufacturing system and ERP enterprise resource planning system. With a registered capital of RMB 58.88 million Yuan, our company has 68 sets of machining centers, CNC machine tools and metal cutting and machining equipment, as well as physical and chemical testing equipment, nondestructive inspectors, spectrum analyzers, three-dimensional measuring machines and valve comprehensive performance testing equipment, with 25 sets for each type of equipment. Our company has obtained the ISO9001 international quality system certificate, API-6D, API607 and API6FA certificates, CE certificate, special equipment production license (TS) issued by the State Technical Supervision Bureau and network access certificates in relevant industries.

The high performance Triple-eccentric and double-eccentric butterfly valves are independently researched, developed and designed by our company and have been granted more than 7 national patents. Our company mainly produces 8 series of products totaling more than 1,500 varieties and specifications including ball valves, butterfly valves and etc. that are anti-wear and anti-corrosive working under high temperature, high pressure and high vacuum with high performances for petroleum, chemical industry, metallurgy, mine, biology, medicine, cryogenic industry, air separation, nuclear power, thermal power, hydropower, machinery, water supply, gas, and oil and gas transportation pipeline and long transportation pipeline and other projects. Nominal diameter DN15-3000mm(1/2" -120"), nominal pressure 1.6Mpa-42Mpa (150LB-2500LB), working temperature -196℃~750℃, valve materials: carbon steel, stainless steel, heat resistant alloy steel, Monel, cryogenic steel and other special steel. Driving modes include manual, electric, pneumatic, gear transmission, worm gear and worm transmission, pneumatic and hydraulic linkage, electric and hydraulic linkage, and computer automatic control system. The products are sold well throughout China and are exported to USA, Europe and other places in the world.



Zero Defect Process Is The Guarantee Of Reliable Performances Of Handa Products.

Strict supervision is the guarantee to product quality. It is our tenet to avoid the occurrence of any defect and prevent quality problem from damaging our brand. We have established a complete set of reasonable and orderly inspection procedures. Guided by the thoughts of "pursuing zero failure", we will never sell one unqualified product to clients. We believe that it not only means the responsibility for customers, but also for ourselves.



High Performance Ball Valves
高性能球阀

成套系统解决方案
Whole-set system solution

- 阀门驱动装置及配件可配套安装，统一提供。
- 可配套提供电动装置、蜗轮装置、双作用气动装置或弹簧回座气动装置，以及各种附件，包括限位装置、电磁阀和定位器。
- The valve actuator and accessories can be offered and installed.
- Electric actuator, worm gear actuator, dual action pneumatic actuator or spring return pneumatic actuator and various accessories including limit device, solenoid valve and positioner can be offered.

HUNAN HANDA VALVE CO., LTD

湖南翰达阀门有限公司

CONTENTS



01 Ball valve model schedule illustration
球阀型号编制说明

03 Floating ball valve
浮动式球阀

14 Trunnion type ball valve
固定式球阀

Devoted to providing valves of reliable performances and excellent quality and related fluid control products and services for the fluid control industry.

致力于为流体控制产业提供性能可靠、品质卓越的阀门及相关流体控制产品和服务



两片式浮动球阀
Two-piece floating ball valve



气动管线球阀
Pneumatic pipeline ball valve



加长杆埋地球阀
Extended stem underground ball valve



手动管线球阀
Manual pipeline ball valve



电动调节管线球阀
Electric regulating pipeline ball valve



Ball valve model schedule illustration

球阀型号编制说明

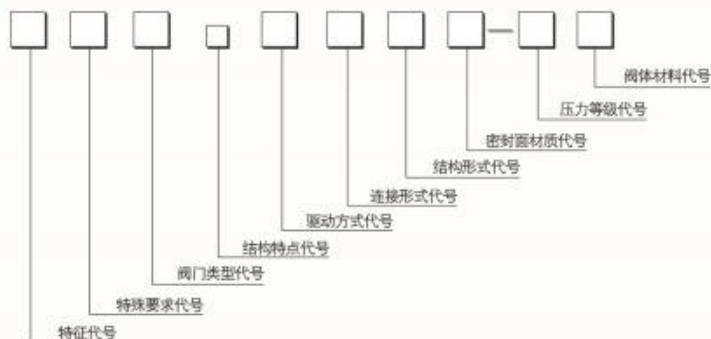

Ball valve model schedule illustration

球阀型号编制说明

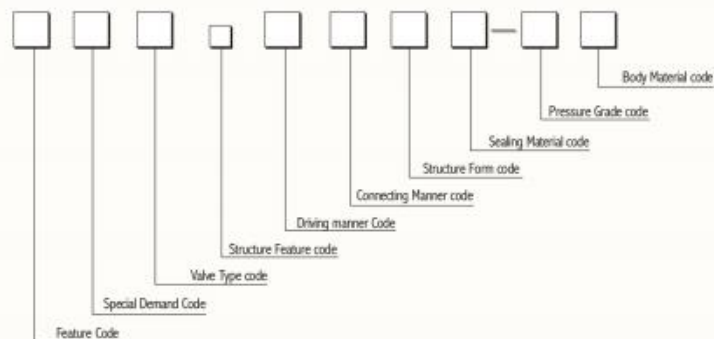

| • 特征代号: | 本公司特征代号为W | | | |
|----------------------------|---|--|-------------------------------|----------------|
| • 特殊要求代号: | K-抗硫型 | D-低温型 | L-加长杆型 | O-氧气专用型 |
| • 阀门内型代号: | Q-球阀 | | | |
| • 结构特点代号: | W-全焊接结构 | T-轨道式 | J-夹套式 | |
| • 驱动方式代号: | 3-蜗轮蜗杆传动 8-气-液联动 | 6-气动 | 6s-手-气动 9(B)电动(防爆型)(手柄传动略) | 7-液动 |
| • 连接形式代号: | 1-内螺纹 7-对夹 | 2-外螺纹 8-卡 | 4-法兰 | 6-焊接 |
| • 结构形式代号: | 1-直通式浮动式 7-直通式固定式 | 4-浮动式L型三通 8-固定式T型三通 | 5-浮动式T型三通 9-固定式L型三通 | |
| • 密封面材质代号: | Y-硬质合金 | F-聚四氟乙烯 | N-尼龙 | PK-PEEK P-对位聚苯 |
| • 压力等级代号: | 公称压力MPa的10倍、磅级为实际数 | | | |
| • 阀体材料代号: (相应零件材质不详细列举) | C-WCB V-WC9, ZG20CrMoV R-CF8M, ZG1Cr18Ni12Mo2Ti L-CF3M F-LCB | I-WC6, ZG1Cr5Mo P-CF8, ZG1Cr18Ni9Ti S-CF3 N-LC3 | | |

注: PN ≥ 2.5MPa及压力等级大于Class150的碳钢阀体, 省略本代号。
 例1: WQ647Y-64R
 表示公称压力为6.4MPa、气动、法兰连接、全通径固定式球阀, 阀体材质为CF8M,密封面为硬质合金。
 例2: WQ967-150
 表示压力等级为Class150、电动、焊接连接、全焊接结构固定式球阀, 阀体材质为碳钢, 密封面为聚四氟乙烯。

| • Feature Code: | The feature code of our company is W | | | |
|---|---|---|--|--------------------------------------|
| • Special Demand Code: | K-anti-sulphur | D-low-temperature type | L-lengthened rod type | O-oxygen specific type |
| • Valve Type Code: | Q-ball valve | | | |
| • Structure Feature Code: | W-Welding Structure | T-Track Type | J-jacketed Type | |
| • Driving manner Code: | 3-worm gear operated 8-air-hydro operated | 6-air-operated | 6s-air-operated with handle tr ansmission 9(B)electric driving(explosion-proof) (handle transmission omit) | 7-hydro dynamically operated |
| • Connecting Manner Code: | 1-internal thread connecting 7-water type | 2-external thread connecting 8-buckle connecting | 4-flange connecting | 6-welded connection |
| • Structure Form Code: | 1-Straight-through Floating Type 7-Straight-through Fixed Type | 4-Floating Type "L" mode Three-way 8-Fixed Type "T" mode Three-way | 5-Floating Type "T" mode Three-way 9-Fixed Type "L" mode Three-way | |
| • Sealing Material Code: | Y-hard alloy | F-polytetrafluoroethylene(PTFE) | N-nylon | PK-PEEK P-Para-positon polyphenylene |
| • Pressure Grade Code: | 10 × nominal rating pressure Mpa the pound grade is actual number | | | |
| • Valve Material Code: (Not list the forging material) | C-WCB V-WC9, ZG20CrMoV R-CF8M, ZG1Cr18Ni12Mo2Ti L-CF3M F-LCB | I-WC6, ZG1Cr5Mo P-CF8, ZG1Cr18Ni9Ti S-CF3 N-LC3 | | |

Notes: PN ≥ 2.5MPa and pressure ≥ carbon steel valve body omits the code.
 Example1: WQ647MY-64R
 Denotes 6.4MPa nominal rating pressure, air-operated, flange full bore transition type ball valve, CF8M valve material, and hard-alloy sealing material.
 Example2: WQ967-150
 Denotes Class 150pressure grade electric driving, welded connection, fixed type 6 welded structure, carbon steel body material and PTFE sealing material.

Floating ball valve

浮动式球阀

产品结构特征

系列浮动式球阀主要适用于天然气、油品、化工、冶金、城建、环保、制药、食品等行业，其中抗硫系列产品适用于含硫化氢介质、杂质多、腐蚀严重的天然气长输管线。

系列浮动式球阀结构特点为：

独特地阀座密封结构

浮动式球阀采用双斜面弹性密封圈结构设计，保证密封的可靠性，对于低压、超低压或真空工况用球阀，采用板簧加载的阀座结构，能确保板簧加载的阀座长期可靠地密封。中、高温球阀的阀座材料可选用对位聚苯或金属材料。

自动泄压结构

当中腔压力出现异常升高现象时，中腔介质能依靠本身的推动阀座而自动泄压，从而确保阀体的安全。

阀杆的可靠密封

阀杆采用有倒密封的下装式结构，倒密封的密封力随介质压力的增高而增大，故能确保阀杆的可靠密封，而且，当阀腔异常升压时，阀杆不会喷出。

产品性能规范

| 压力等级 | | 1.6-42.0MPa | Class150-2500 |
|---------------|-----------------|-------------|---------------|
| 试验压力 (MPa) | 强度试验 | 1.5 × PN | |
| | 密封试验 | 1.1 × PN | |
| | 超亚密封试验 | 0.6MPa | |
| 工作温度 | -196℃~+180℃ | | |
| 工作介质 | 水、油品、天然气、腐蚀性介质等 | | |

注：PN为主体材料在38℃时允许的额定工作压力

防火结构

根据工况及用户的需要，球阀可设计为防火结构。球阀的耐火设计执行API607、API6FA及JB/T6899等标准的规定，一旦发生火灾而使软密封圈烧损时，球阀的防火结构可阻止介质的大量泄漏，防止火灾的进一步扩大。

防静电结构

当操作阀门时，由于球体和阀座之间的摩擦，会产生静电电荷并积聚在球体上，为防止产生静电火花，特在阀门上设置防静电装置，将积聚在球体上的电荷导出。

锁定装置

在手动球阀的全开、全闭两点位置上设计可上锁的结构，这样，可防止误操作以及不可预知的线路振动而产生的不应有的开关现象，特别是在可燃介质的石油类和化学的生产线，以及阀门在室外配管时，这种设计体现出的优点和实际效果特别好。

全通径结构及□径结构

为满足用户的不同需要，本公司球阀产品有全通径及□径两种系列。全通径球阀的通道内径与管道内径一致，便于管理清扫，而缩径系列球阀的重量相对较轻，但流体阻力仅为相同口径缩径阀的1/7左右，故缩径系列球阀的应用前景较为广阔。

Floating ball valve

浮动式球阀

Product Design Features

Series floating ball valves are mainly applied to natural gas, oil products, chemical engineering, metallurgy, city building, environment protection, pharmacy and food industries, among which the anti-sulphur series are used for long delivery pipes of natural gas that contains hydrogen sulphide medium, a lot of impurity and corrosive substances.

The design features of the floating ball valves include:

Specific Sealing Structure of Valve Base

Double cant elastic seal ring or V-shaped groove seal ring structural design is adopted to ensure sealing reliability. For low-pressure, ultralow pressure or vacuum-operated ball valves, a plate spring-loaded sealing structure of valve base is adopted for valve base material.

Automatic pressure relief structure

When the pressure in cloaca cavity increases singularly, the cavity medium can push valve base by its own thrusting force, which results in automatic pressure relief and valve security assurance.

Reliable Sealing of valve Rod

The valve rod adopts downward installation structure with back sealing. The sealing force will increase together with the heightening of medium pressure, which can ensure the sealing. Moreover, even if the pressure in valve cavity increases singularly, the valve rod will not burst out.

Fire-resistant Structure

According to the operating condition and users requirement, ball valve can be designed with a fire resistant structure up to the fire-resistant standards of API607, API6FA and JB/T6899. Once the soft ring is burnt out on fire, the structure can avoid serious leaking of the medium and prevent the fire from scaling up.

Anti-static Structure

While operating the valve, the friction between the sphere and base will produce static charges accumulating on the sphere. To avoid static sparkle, the fire-resistant device is designed to derive the accumulated static sparkle, charges from the sphere.

Locking Device

A locking structure is designed on the full-open and full-close spots of ball valves to avoid abnormal open-and-close produced by misoperation or unpredictable circuit vibration. On production lines of petroleum and chemicals of flammable mediums, and during the course of outdoor piping, the design is especially advantageous and practical.

Full Bore Structure and Reduced Bore Structure

The two structure series are produced to meet different requirements of users. The passage inside diameter of full diameter ball valves is the same as that of valve pipe, which is convenient for pipe cleaning. The weight of retractive diameter ball valves is relatively lighter, but the fluid resistance is just 1/7 that of stop valves with the same caliber. Therefore, the application prospects of retractive diameter series is much better.

Products Performance Specification

| Pressure grade | | 1.6-42.0MPa | Class150-2500 |
|------------------------|---|-------------|---------------|
| Test pressure (Mpa) | Shell test | 1.5 × PN | |
| | Sealing test | 1.1 × PN | |
| | Air test pressure | 0.6MPa | |
| Working temperature | -196℃~+180℃ | | |
| Working medium | Water, oil, natural gas, corrosive medium, etc. | | |

Note: PN is requested for the body material under the 38℃.

Floating ball valve

浮动式球阀

| 产品规格 Products specification | | | | | | |
|--|--|---------------|---------------|--------------|--------------|--|
| 系列型号 Serial Model | W(K)Q41, W(K)Q341, W(K)Q641, W(K)Q741, W(K)Q841, W(K)Q941, W(K)Q61, W(K)Q361, W(K)Q661, W(K)Q761, W(K)Q861, W(K)Q961. | | | | | |
| 压力等级范围 Pressure Grade Range | PN1.6~10.0MPa | | CLASS150~600 | | | |
| 公称通径范围 Nominal size | DN15~200mm | | 1/2"~8" | | | |
| 驱动方式及 适用范围 Driving Manner and Scope of Application | 手柄驱动 Handle driving | PN1.6~10.0MPa | | CLASS150~600 | | |
| | | DN15~200mm | | 1/2"~8" | | |
| | 蜗轮蜗杆驱动 Worm gear operated | PN1.6~4.0MPa | PN6.4~10.0MPa | CLASS150~300 | CLASS400~600 | |
| | | DN150~200 | DN80~100 | 6"~8" | 3"~4" | |
| | 气动/液动 Air-operation and fluid driving | PN1.6~10.0MPa | | CLASS150~600 | | |
| DN15~200mm | | 1/2"~8" | | | | |
| 电动 Electric driving | PN1.6~4.0MPa | PN6.4~10.0MPa | CLASS150~300 | CLASS400~600 | | |
| | DN50~200 | DN50~100 | 2"~8" | 2"~4" | | |

*注：本公司可根据用户要求提供产品。

*Notes: our company can provide products at customer's requirement.

| 浮动式球阀力矩表 (N.m) Floating ball valve torque form(N.m) | | | | | | | | | | | | | | |
|---|----------------|----|----|-----|-----|-----|-----|-----|-----|-----|-----|-----|--|--|
| 压力 Pressure(Mpa) | 通径 Size(mm) | 通径 | | | | | | | | | | | | |
| | | 15 | 20 | 25 | 40 | 50 | 65 | 80 | 100 | 125 | 150 | 200 | | |
| 1.6 | 3 | 5 | 10 | 16 | 25 | 50 | 65 | 125 | 250 | 340 | 485 | | | |
| 2.5 | 3 | 5 | 11 | 18 | 30 | 60 | 80 | 140 | 300 | 400 | 680 | | | |
| 4.0 | 5 | 10 | 24 | 35 | 50 | 100 | 150 | 250 | 450 | 585 | 996 | | | |
| 6.4 | 15 | 30 | 50 | 80 | 100 | 200 | 300 | 400 | - | - | - | | | |
| 10.0 | 19 | 35 | 68 | 130 | 190 | 360 | 460 | 770 | - | - | - | | | |

*注：表中所列数据未经实际测定，仅供参考。

*Notes: The data in the form are not practically measured, and just for reference.

| 压力 Pressure(Mpa) | 通径 Size(mm) | 通径 | | | | | | | | | | | | |
|---------------------|----------------|-----|-----|-----|-------|-----|-------|-----|-----|-----|------|---|--|--|
| | | 1/2 | 3/4 | 1 | 1 1/2 | 2 | 2 1/2 | 3 | 4 | 5 | 6 | 8 | | |
| 150 | 3 | 5 | 11 | 16 | 25 | 50 | 65 | 125 | 250 | 410 | 700 | | | |
| 300 | 7 | 12 | 26 | 38 | 60 | 120 | 160 | 280 | 600 | 950 | 1550 | | | |
| 400 | 15 | 30 | 50 | 90 | 140 | 240 | 350 | 540 | - | - | - | | | |
| 600 | 19 | 35 | 68 | 130 | 190 | 360 | 460 | 770 | - | - | - | | | |

*注：表中所列数据未经实际测定，仅供参考。

*Notes: The data in the form are not practically measured, and just for reference.

Cast steel floating ball valve

浮动式铸钢球阀

W(K)Q(3、6、7、8、9)4(6)1F(N、P)



主要零件材质 Form of Major Parts Materials

| 序号 No. | 零件名称 Part name | 材质 Material | |
|-----------|-----------------------|--------------------------------------|--------------------------------------|
| | | GB | ASTM |
| 1 | 阀壳体 Bonnet | WCB | A216-WCB |
| 2 | 螺母 Nut | 35 | A194-2H |
| 3 | 垫片 Gasket | 柔性石墨+不锈钢 Graphite+stainless steel | 柔性石墨+不锈钢 Graphite+stainless steel |
| 4 | 螺栓 Bolt | 35CrMoA | A193-B7 |
| 5 | 壳体 Body | WCB | A216-WCB |
| 6 | 阀座 Seat | PTFE | PTFE |
| 7 | 球体 Ball* | 25+ENP | A105+ENP |
| 8 | 阀杆** Stem** | 1Cr13 | A182-F6a |
| 9 | 垫片 Gasket | PTFE | PTFE |
| 10 | 填料 Packing | 柔性石墨 Flexible Graphite | 柔性石墨 Flexible Graphite |
| 11 | 填料压盖 Gland | WCB | A216-WCB |
| 12 | 螺钉 Screw nail | 35 | A194-2H |
| 13 | 定位片 Locating piece | Q235A | 碳钢 Carbon steel |
| 14 | 挡圈 Ring | 65Mn | AISI 1566 |
| 15 | 手柄 Wrench | KT330-08 | A47-667 32510 |

注：*抗硫型阀门该零件的材质为GB(1Cr18Ni9+Ni.P).

ASTM (A182-304+Ni.P)

**抗硫型阀门该零件的材质为GB(1Cr18Ni9). ASTM(A276-321)

系列阀门主要零部件及密封面的材质可根据实际工况条件或用户特殊要求设计选用。

Notes: * The material of this part about the anti-sulphur type valve is GB(1Cr18Ni9+ Ni.P) ASTM (A182-304+Ni.P)

** The material of this part about the anti-sulphur type valve is GB(1Cr18Ni9) ASTM(A276-321)

Major parts of the valve series and materials of sealing surface differ according to actual working condition and customer's special requirement.

技术规范 Technical specification

| 设计标准 Design Standard | GB/T 12237 | API 608 |
|----------------------------|-------------------|-------------|
| 结构长度 Face to Face | GB/T 12221 | ASME B16.10 |
| 法兰尺寸 Flanged Size | GB/T 9113 JB/T 79 | ASME B16.5 |
| 检查与试验 Test & Inspection | JB/T 9092 | API 598 |

*注：系列阀门连接法兰及对接端尺寸可根据用户要求设计制造。

*Notes: The sizes of serial valve connecting flange and butt-welding terminal can be designed according to customer's requirement.

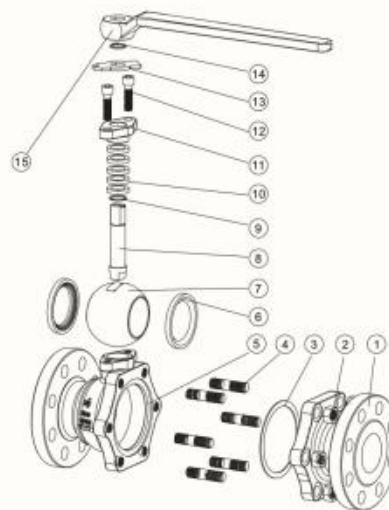

Cast steel floating ball valve

浮动式铸钢球阀

W(K)Q(3、6、7、8、9)4(6)1F(Y、N、P)

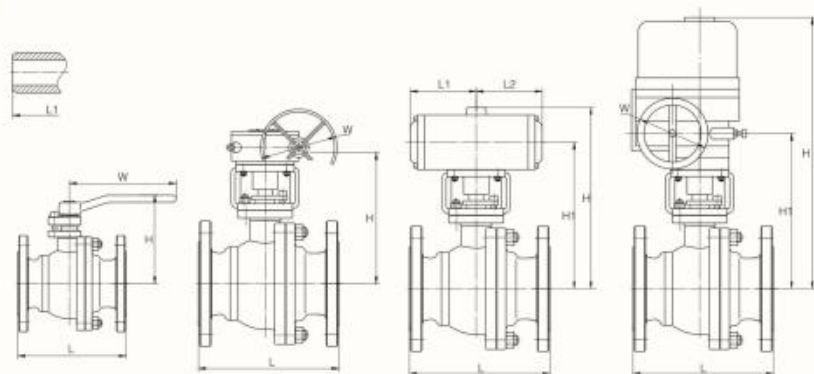

尺寸及重量 Size and weight

PN1.6MPa CLASS 150

| DN | mm | 15 | 20 | 25 | 40 | 50 | 80 | 100 | 125 | 150 | 200 | |
|------------------------------|------------|------|------|------|-------|-------|-------|-------|-------|--------|--------|--------|
| NPS | in | 1/2 | 3/4 | 1 | 1 1/2 | 2 | 2 1/2 | 3 | 4 | 5 | 6 | 8 |
| 法兰 Flange | L | 130 | 130 | 140 | 165 | 203 | 222 | 241 | 305 | 356 | 394 | 457 |
| | L1 | 140 | 152 | 165 | 190 | 216 | 241 | 282 | 305 | 381 | 403 | 419 |
| 对焊 Butt Welding | H | 59 | 63 | 75 | 95 | 107 | 142 | 152 | 178 | 252 | 272 | 342 |
| | W | 130 | 130 | 160 | 230 | 230 | 350 | 400 | 500 | 750 | 750 | 900 |
| 手动 Hand-Operated | Kg | 2.3 | 3.0 | 4.5 | 7.0 | 9.5 | 15.0 | 19.0 | 33.0 | 58.0 | 93.0 | 1600 |
| | H | - | - | - | - | - | - | - | - | - | 292 | 398 |
| 蜗轮蜗杆传动 Worm Gear Operated | W | - | - | - | - | - | - | - | - | - | 400 | 600 |
| | 型号 Type | - | - | - | - | - | - | - | - | - | A | B |
| Kg | - | - | - | - | - | - | - | - | - | - | 180 | 240 |
| | H | 200 | 204 | 257 | 264 | 340 | 370 | 389 | 594 | 646 | 646 | 781 |
| 气动 Air-Operating | H1 | 122 | 126 | 162 | 169 | 209 | 239 | 258 | 337 | 437 | 437 | 537 |
| | L1 | 326 | 326 | 347 | 420 | 426 | 426 | 590 | 523 | 610 | 610 | 885 |
| L2 | 136 | 136 | 181 | 181 | 257 | 257 | 257 | 287 | 378 | 378 | 530 | |
| | 型号 Type | AG06 | AG09 | AG09 | AG13 | AG13 | AG13 | AG13 | AW13 | AW17 | AW17 | AW20 |
| Kg | 6.1 | 6.3 | 8.1 | 14.1 | 16.6 | 38 | 42.1 | 53 | 95.3 | 105.2 | 207.8 | |
| | H | - | - | - | - | 472 | 486 | 579 | 595 | 650 | 739 | 799 |
| 电动 Electric Driving | H1 | - | - | - | - | 377 | 391 | 484 | 500 | 500 | 589 | 649 |
| | W | - | - | - | - | 190 | 190 | 190 | 190 | 400 | 400 | 400 |
| Kg | - | - | - | - | - | Q60-1 | Q60-1 | Q60-1 | Q60-1 | Q120-1 | Q120-1 | Q120-1 |
| | - | - | - | - | - | 23 | 25 | 60 | 75 | 97 | 162 | 226 |



Cast steel floating ball valve

浮动式铸钢球阀

W(K)Q(3、6、7、8、9)4(6)1F(Y、N、P)

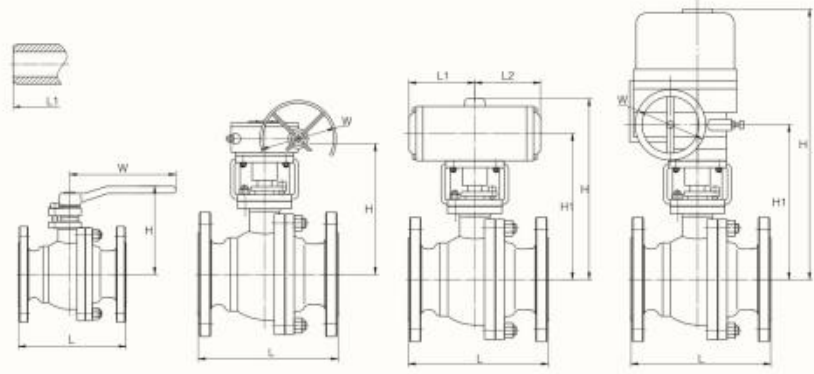

尺寸及重量 Size and weight

PN2.5 4.0MPa CLASS 300

| DN | mm | 15 | 20 | 25 | 40 | 50 | 80 | 100 | 125 | 150 | 200 | |
|------------------------------|------------|------|------|------|-------|-------|-------|-------|-------|--------|--------|--------|
| NPS | in | 1/2 | 3/4 | 1 | 1 1/2 | 2 | 2 1/2 | 3 | 4 | 5 | 6 | 8 |
| 法兰 Flange | L | 140 | 152 | 165 | 200 | 230 | 290 | 310 | 350 | 381 | 403 | 502 |
| | L1 | 140 | 152 | 165 | 190 | 216 | 241 | 282 | 305 | 381 | 403 | 502 |
| 对焊 Butt Welding | H | 59 | 63 | 75 | 95 | 167 | 142 | 152 | 178 | 252 | 272 | 342 |
| | W | 130 | 130 | 160 | 230 | 230 | 350 | 400 | 500 | 750 | 750 | 900 |
| 手动 Hand-Operated | Kg | 2.5 | 3.5 | 5.5 | 10.5 | 14.5 | 23.5 | 30 | 55 | 81 | 118 | 200 |
| | H | - | - | - | - | - | - | - | - | - | 292 | 398 |
| 蜗轮蜗杆传动 Worm Gear Operated | W | - | - | - | - | - | - | - | - | - | 400 | 600 |
| | 型号 Type | - | - | - | - | - | - | - | - | - | A | B |
| Kg | - | - | - | - | - | - | - | - | - | - | 220 | 365 |
| | H | 200 | 204 | 257 | 264 | 340 | 379 | 452 | 594 | 646 | 744 | 920 |
| 气动 Air-Operating | H1 | 122 | 126 | 162 | 169 | 209 | 248 | 295 | 375 | 437 | 500 | 615 |
| | L1 | 326 | 326 | 347 | 420 | 426 | 426 | 590 | 523 | 610 | 610 | 885 |
| L2 | 136 | 136 | 181 | 181 | 257 | 257 | 257 | 287 | 378 | 378 | 530 | |
| | 型号 Type | AG06 | AG09 | AG09 | AG13 | AG13 | AG13 | AG13 | AW13 | AW17 | AW17 | AW20 |
| Kg | 6.2 | 6.4 | 8.5 | 16.9 | 20.9 | 42.5 | 52.7 | 77.9 | 107 | 130 | 220 | |
| | H | - | - | - | - | 472 | 472 | 579 | 595 | 650 | 739 | 799 |
| 电动 Electric Driving | H1 | - | - | - | - | 377 | 391 | 484 | 500 | 500 | 589 | 649 |
| | W | - | - | - | - | 190 | 190 | 190 | 190 | 400 | 400 | 400 |
| Kg | - | - | - | - | - | Q60-1 | Q60-1 | Q60-1 | Q60-1 | Q120-1 | Q120-1 | Q120-1 |
| | - | - | - | - | - | 23 | 25 | 60 | 75 | 97 | 162 | 226 |

Cast steel floating ball valve

浮动式铸钢球阀

W(K)Q(3、6、7、8、9)4(6)1F(Y、N、P)

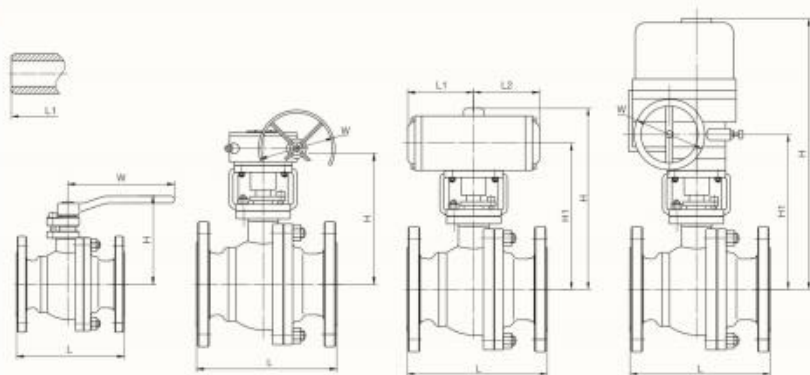

尺寸及重量 Size and weight

PN6.4 10.0MPa CLASS 400 600

| DN | mm | 15 | 20 | 25 | 40 | 50 | 65 | 80 | 100 | 125 | 150 | 200 |
|-------------------------------------|------------|------|------|------|-------|--------|--------|--------|-----------|-----|-----|-----|
| NPS | | 1/2 | 3/4 | 1 | 1 1/2 | 2 | 2 1/2 | 3 | 4 | 5 | 6 | 8 |
| 法兰 Flange | L | 165 | 190 | 216 | 200 | 230 | 290 | 310 | 350 | - | - | - |
| 对焊 Butt Welding | L1 | 165 | 190 | 216 | 241 | 292 | 330 | 356 | 406(432)* | - | - | - |
| 手动 Hand-Operated | H | 59 | 63 | 75 | 95 | 167 | 180 | 198 | 198 | - | - | - |
| | W | 160 | 160 | 230 | 400 | 400 | 650 | 650 | 1050 | - | - | - |
| 蜗轮蜗 杆传动 Worm Gear Operated | H | - | - | - | - | - | - | 292 | 398 | - | - | - |
| | W | - | - | - | - | - | 400 | 600 | 600 | - | - | - |
| 气动 Air-Operating | 型号 Type | - | - | - | - | - | A | B | - | - | - | - |
| | H | 200 | 204 | 241 | 264 | 340 | 379 | 452 | 584 | - | - | - |
| | H1 | 122 | 145 | 146 | 169 | 209 | 248 | 295 | 375 | - | - | - |
| | L1 | 283 | 283 | 283 | 350 | 590 | 590 | 523 | 610 | - | - | - |
| 电动 Electric Driving | L2 | 136 | 181 | 181 | 181 | 257 | 257 | 287 | 378 | - | - | - |
| | 型号 Type | AG09 | AG09 | AG09 | AG09 | AG13 | AG13 | AG13 | AW17 | - | - | - |
| | H | 6.5 | 6.8 | 9.3 | 17.8 | 33.6 | 45.1 | 59.3 | 81.2 | - | - | - |
| | H1 | - | - | - | - | 472 | 599 | 599 | 632 | - | - | - |
| 电动 Electric Driving | W | - | - | - | - | 190 | 190 | 190 | 190 | - | - | - |
| | 型号 Type | - | - | - | - | Q120-1 | Q120-1 | Q120-1 | Q120-1 | - | - | - |
| | Hg | - | - | - | - | 25 | 60 | 75 | 90 | - | - | - |

* ()内为PN10.0MPa、Class600尺寸

** () the dimension in Parenthesis is for PN10.0, Class 600.



Forged steel floating ball valve

浮动式锻钢球阀

W(K)Q(3、6、7、8、9)4(6)1F(Y、N、P)



主要零件材质 Form of Major Parts Materials

| 序号 No. | 零件名称 Part name | 材质 Material | |
|-----------|-----------------------|--------------------------------------|--------------------------------------|
| | | GB | ASTM |
| 1 | 垫片 Gasket | 柔性石墨+不锈钢 Graphite+stainless steel | 柔性石墨+不锈钢 Graphite+stainless steel |
| 2 | 阀座 Seat | PTFE | PTFE |
| 3 | 右体 Bonnet | 25 | A105 |
| 4 | 螺母 Nut | 35 | A194-2H |
| 5 | 螺栓 Bolt | 35CrMoA | A193-B7 |
| 6 | 阀体 Body | 25 | A105 |
| 7 | 球体* Ball* | 25+ENP | A105+ENP |
| 8 | 阀杆** Stem** | 1Cr13 | A182-F6a |
| 9 | 垫片 Gasket | PTFE | PTFE |
| 10 | 填料垫 Packing seat | 1Cr13 | A276-410 |
| 11 | 填料 Flecking | 柔性石墨 Flexible Graphite | 柔性石墨 Flexible Graphite |
| 12 | 填料压盖 Gland | WCB | A216-WCB |
| 13 | 螺栓 Bolt | 35CrMoA | A193-B7 |
| 14 | 定位片 Locating piece | Q235A | 碳钢 Carbon steel |
| 15 | 垫圈 Ring | 65Mn | AISI 1566 |
| 16 | 手柄 Wrench | KT330-08 | A47-667 32510 |

注：*抗硫型阀门该零件的材质为GB(1Cr18Ni9+NLP)、ASTM(A182-304+NLP)

**抗硫型阀门该零件的材质为GB(1Cr18Ni9)、ASTM(A276-321)系列阀门主要零件及密封面的材质可根据实际工况及条件或用户特殊要求设计选用。

Notes: * The material of this part about the anti-sulphur type valve is GB(1Cr18Ni9+NLP) ASTM(A182-304+NLP)

** The material of this part about the anti-sulphur type valve is GB(1Cr18Ni9) ASTM(A276-321) Major parts of the valve series and materials of sealing surface differ according to actual working condition and customer's special requirement.

技术规范 Technical specification

| 设计标准 Design Standard | GB/T 12237 | API 608 |
|----------------------------|-------------------|-------------|
| 结构长度 Face to Face | GB/T 12221 | ASME B16.10 |
| 法兰尺寸 Flanged Size | GB/T 9113 JB/T 79 | ASME B16.5 |
| 检查与试验 Test & Inspection | JB/T 9092 | API 598 |

* 注：系列阀门连接法兰及对焊端尺寸可根据用户要求设计制造。

* Notes: The sizes of serial valve connecting flange and butt-welding terminal can be designed according to customer's requirement.

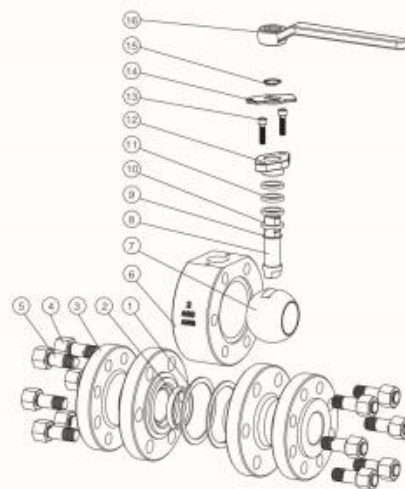

Forged steel floating ball valve

浮动式锻钢球阀

W(K)Q(3、6、7、8、9)4(6)1F(Y、N、P)

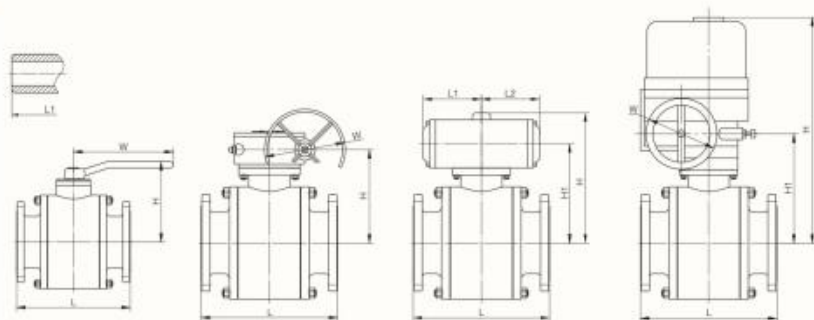

尺寸及重量 Size and weight

PN1.6MPa CLASS 150

| DN | mm | 15 | 20 | 25 | 40 | 50 | 65 | 80 | 100 | 125 | 150 | 200 |
|------------------------------|------------|------|------|------|-------|-------|-------|-------|-------|--------|--------|--------|
| NPS | in | 1/2 | 3/4 | 1 | 1 1/2 | 2 | 2 1/2 | 3 | 4 | 5 | 6 | 8 |
| 法兰 Flange | L | 108 | 117 | 127 | 165 | 178 | 190 | 203 | 229 | 356 | 394 | 457 |
| 对焊 Butt Welding | L1 | 140 | 152 | 165 | 190 | 216 | 241 | 282 | 305 | 381 | 403 | 419 |
| 手动 Hand-Operated | H | 73 | 78 | 86 | 102 | 130 | 142 | 191 | 200 | 226 | 242 | 285 |
| | W | 130 | 130 | 160 | 180 | 230 | 400 | 400 | 460 | 750 | 750 | 900 |
| 蜗轮蜗杆传动 Worm Gear Operated | H | - | - | - | - | - | - | - | - | - | 260 | 300 |
| | W | - | - | - | - | - | - | - | - | - | 400 | 600 |
| 气动 Air-Operating | H | 203 | 234 | 242 | 326 | 354 | 366 | 415 | 485 | 607 | 623 | 742 |
| | H1 | 125 | 139 | 147 | 195 | 223 | 235 | 284 | 328 | 398 | 414 | 498 |
| 电动 Electric Driving | L1 | 326 | 326 | 347 | 420 | 426 | 426 | 590 | 523 | 610 | 610 | 885 |
| | L2 | 136 | 136 | 181 | 181 | 257 | 257 | 257 | 287 | 378 | 378 | 530 |
| 手动 Hand-Operated | 型号 Type | AG06 | AG09 | AG09 | AG13 | AG13 | AG13 | AG13 | AW13 | AW17 | AW17 | AW20 |
| | Kg | 6.1 | 6.3 | 8.1 | 14.1 | 16.6 | 38.0 | 42.1 | 53.0 | 93.5 | 105.2 | 207.8 |
| 蜗轮蜗杆传动 Worm Gear Operated | H | - | - | - | - | 432 | 443 | 454 | 493 | 574 | 646 | 678 |
| | H1 | - | - | - | - | 337 | 348 | 359 | 398 | 424 | 496 | 528 |
| 气动 Air-Operating | W | - | - | - | - | 190 | 190 | 190 | 190 | 400 | 400 | 400 |
| | 型号 Type | - | - | - | - | Q60-1 | Q60-1 | Q60-1 | Q60-1 | Q120-1 | Q120-1 | Q120-1 |
| 电动 Electric Driving | Kg | - | - | - | - | 23 | 25 | 60 | 75 | 97 | 162 | 226 |

Forged steel floating ball valve

浮动式锻钢球阀

W(K)Q(3、6、7、8、9)4(6)1F(Y、N、P)

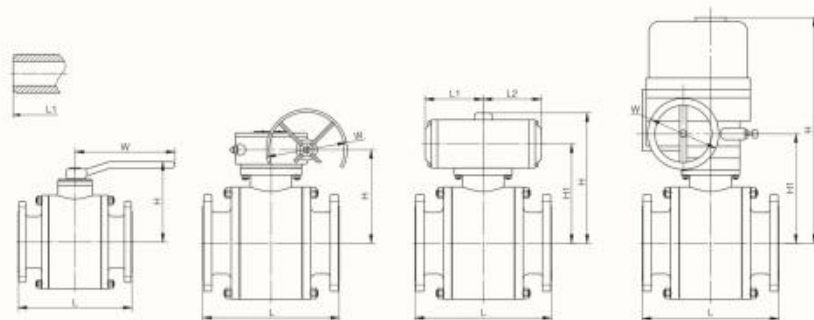

尺寸及重量 Size and weight

PN2.5 4.0MPa CLASS 300

| DN | mm | 15 | 20 | 25 | 40 | 50 | 65 | 80 | 100 | 125 | 150 | 200 |
|------------------------------|------------|------|------|------|-------|-------|-------|-------|-------|--------|--------|--------|
| NPS | in | 1/2 | 3/4 | 1 | 1 1/2 | 2 | 2 1/2 | 3 | 4 | 5 | 6 | 8 |
| 法兰 Flange | L | 140 | 152 | 165 | 190 | 216 | 241 | 282 | 305 | 381 | 403 | 502 |
| 对焊 Butt Welding | L1 | 140 | 152 | 165 | 190 | 216 | 241 | 282 | 305 | 381 | 403 | 502 |
| 手动 Hand-Operated | H | 73 | 80 | 86 | 102 | 136 | 164 | 191 | 223 | 240 | 253 | 307 |
| | W | 140 | 140 | 180 | 230 | 240 | 400 | 400 | 750 | 750 | 900 | 1000 |
| 蜗轮蜗杆传动 Worm Gear Operated | H | - | - | - | - | - | - | - | - | - | 325 | 387 |
| | W | - | - | - | - | - | - | - | - | - | 400 | 600 |
| 气动 Air-Operating | H | 204 | 236 | 242 | 326 | 359 | 388 | 415 | 508 | 621 | 675 | 824 |
| | H1 | 126 | 141 | 147 | 195 | 228 | 257 | 284 | 351 | 412 | 466 | 580 |
| 手动 Hand-Operated | L1 | 326 | 326 | 347 | 420 | 426 | 426 | 590 | 523 | 610 | 610 | 885 |
| | L2 | 136 | 136 | 181 | 181 | 257 | 257 | 257 | 287 | 378 | 378 | 530 |
| 蜗轮蜗杆传动 Worm Gear Operated | 型号 Type | AG06 | AG09 | AG09 | AG13 | AG13 | AG13 | AG13 | AW13 | AW17 | AW17 | AW20 |
| | Kg | 6.2 | 6.4 | 8.5 | 16.9 | 20.9 | 42.5 | 52.7 | 77.9 | 107.0 | 130 | 220 |
| 气动 Air-Operating | H | - | - | - | - | 432 | 443 | 454 | 493 | 574 | 646 | 678 |
| | H1 | - | - | - | - | 337 | 348 | 359 | 398 | 424 | 496 | 528 |
| 手动 Hand-Operated | W | - | - | - | - | 190 | 190 | 190 | 190 | 400 | 400 | 400 |
| | 型号 Type | - | - | - | - | Q60-1 | Q60-1 | Q60-1 | Q60-1 | Q120-1 | Q120-1 | Q120-1 |
| 电动 Electric Driving | Kg | - | - | - | - | 23 | 35 | 60 | 75 | 100 | 170 | 245 |

Forged steel floating ball valve

浮动式锻钢球阀

W(K)Q(3、6、7、8、9)4(6)1F(Y、N、P)

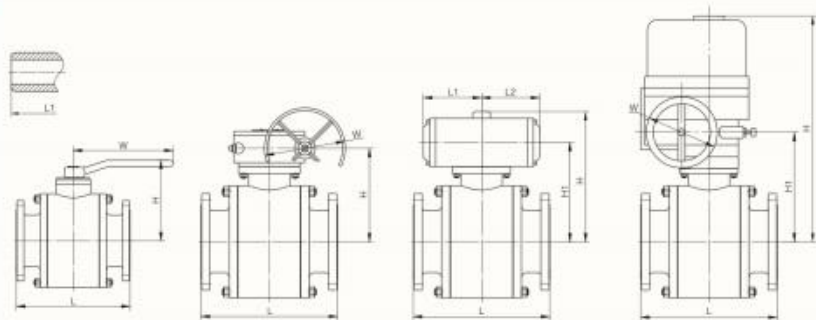

尺寸及重量 Size and weight

PN6.4 10.0MPa CLASS 400 600

| DN | mm | 15 | 20 | 25 | 40 | 50 | 65 | 80 | 100 |
|-------------------------------------|----|------|------|------|-------|--------|--------|--------|-----------|
| NPS | in | 1/2 | 3/4 | 1 | 1 1/2 | 2 | 2 1/2 | 3 | 4 |
| 法兰 Flange | L | 165 | 190 | 216 | 241 | 292 | 330 | 356 | 406(432)* |
| 对焊 Butt Welding | L1 | 165 | 190 | 216 | 241 | 292 | 330 | 356 | 406(432) |
| 手动 Hand-Operated | H | 73 | 80 | 86 | 110 | 142 | 171 | 185 | 220 |
| | W | 160 | 160 | 230 | 400 | 400 | 650 | 650 | 800 |
| 蜗轮蜗 杆传动 Worm Gear Operated | H | - | - | - | - | - | - | 182 | 217 |
| | W | - | - | - | - | - | - | 280 | 400 |
| | 型号 | - | - | - | - | - | - | 0 | A |
| | Kg | - | - | - | - | - | - | 50 | 95 |
| 气动 Air-Operating | H | 229 | 236 | 242 | 266 | 366 | 395 | 470 | 601 |
| | H1 | 134 | 141 | 147 | 171 | 235 | 264 | 313 | 392 |
| | L1 | 283 | 283 | 283 | 350 | 590 | 590 | 523 | 610 |
| | L1 | 136 | 181 | 181 | 181 | 257 | 257 | 287 | 378 |
| | 型号 | AG09 | AG09 | AG09 | AG09 | AG13 | AG13 | AG13 | AW17 |
| 电动 Electric Driving | Kg | 6.5 | 6.8 | 9.3 | 17.8 | 33.6 | 45.1 | 55.3 | 81.3 |
| | H | - | - | - | - | 500 | 520 | 545 | 558 |
| | H1 | - | - | - | - | 350 | 370 | 395 | 408 |
| | W | - | - | - | - | 190 | 190 | 190 | 190 |
| | 型号 | - | - | - | - | Q120-1 | Q120-1 | Q120-1 | Q120-1 |
| Kg | - | - | - | - | 26 | 41 | 72 | 92 | |

(*)内为PN10.0MPa、Class600尺寸



Trunnion type ball valve

固定式球阀

产品结构特征

系列固定式球阀主要适用于天然气、油品、化工、冶金、城建、环保、制药、食品等行业，其中抗硫系列产品适用于含硫化氢介质、杂质多、腐蚀严重的天然气长输管线。

系列固定式球阀结构特点为：

壳体结构

固定式球阀的壳体根据用户需要及实际工况条件的不同可设计为铸造结构、锻造结构及全焊接结构三种形式，其中全焊接结构的球阀主要适用于埋地使用。

独特的阀座密封结构

固定式球阀根据压力的大小、介质性质及密封要求的不同而选择球阀前密封结构、球后密封结构或前球后双密封结构。

自动泄压结构

当中腔压力出现异常升高现象时，单密封结构球阀具有自动泄压机能。而双密封结构的球阀则由壳体上的附加泄压装置进行泄压。

密封的紧急救护

阀座及阀杆密封件出现损伤而引起泄漏时，通过注脂阀注入的密封脂可起到临时密封作用。

防火结构

根据工况及用户的需要，球阀可设计为防火结构。球阀的防火设计执行API 607、API 6FA及JB/T 6899等标准的规定。一旦发生火灾而使软密封副烧损时，球阀的防火结构可阻止介质的大量泄漏，防止火灾的进一步扩大。

产品性能规范

| 压力等级 | 1.6-25.0MPa | Class 150-1500 |
|---------------|-----------------|----------------|
| 试验压力 (MPa) | 强度试验 | 1.5 × PN |
| | 密封试验 | 1.1 × PN |
| | 气压密封试验 | 0.6MPa |
| 工作温度 | -196℃~+121℃ | |
| 工作介质 | 水、油品、天然气、腐蚀性介质等 | |

注：PN为壳体材料在38℃时允许的额定工作压力

防静电结构

当操作阀门时，由于球体和阀座之间的摩擦，会产生静电电荷并积聚在球体上。为防止产生静电火花，特在阀门上设置防静电装置，将积聚在球上的电荷导出。

阻塞与排泄

当阀门处于关闭状态时，上下游侧的阀座使流体阻断，阀体中腔的积液物可以通过排泄装置进行排泄。

锁定装置

在手动球阀的全开、全闭两点位置上设计可上锁的结构，这样，可防止误操作以及不可预知的线路波动而产生的不应有的开关现象，特别是在可燃性介质的石油类和化学药品的生产线，以及阀门在室外配管时，这种设计体现出的优点和实际效果特别明显。

全通径结构及缩径结构

为满足用户的不同需要，本公司球阀产品有全通径及缩径两种系列。全通径球阀的通道内径与管道内径一致，便于管理清扫。而缩径系列球阀的重量相对较轻，但流体阻力仅为相同口径截止阀的1/7左右，故缩径系列球阀的应用前景较为广阔。

Trunnion type ball valve

固定式球阀

Product Design Features

Serial floating ball valves are mainly applied to natural gas, oil products, chemical engineering, metallurgy, city building, environment protection, pharmacy and food industries, among which the anti-sulphur series are used for long delivery pipes of natural gas that contains hydrogen sulphide medium, a lot of impurity and corrosive substances.

The design features of the floating ball valves include:

Construction of the shell

The valve bush of the stationary ball valve can be designed to three types: casting construction, forging construction, and full welding construction, according to user's demand or different working condition. And the ball valve of the full welding construction is mainly applied to underground operation.

The unique sealed structure of valve seat

Pre-ball sealed structure, post-ball sealed structure or pre-post-ball double sealed structures are available for choosing to different pressure, medium properties, and sealing requirements of the fixed ball valves.

Automatic pressure-relieving structure

When an abnormal rising of pressure appear in the hollow cavity, the single sealed-structure takes on the function of automatic pressure relieving, while the double-sealed structure can finish the job through a attached pressure-relieving device to the valve body.

Emergent repairman for the sealed structure

When leak was caused by damage on the valve seat or valve stick, the sealed grease injected through the grease feeding valve can seal the valve at once.

Products Performance Specification

| | | | |
|---------------------|-------------------|---|----------------|
| Pressure grade | | 1.6~25.0MPa | Class 150~1500 |
| Test pressure (Mpa) | Shell test | 1.5 × PN | |
| | Sealing test | 1.1 × PN | |
| | Air test pressure | 0.6MPa | |
| Working temperature | | -196℃~+121℃ | |
| Working medium | | Water, oil, natural gas, corrosive medium, etc. | |

Note: PN is requested pressure for the body material under the 38℃.

Fire-resistant Structure

According to the operating condition and user's requirement, ball valve can be designed with a fire-resistant structure up to the fire resistant standards of API607, API 6FA and JB/T6899. Once the soft seal ring is burnt out on fire, the structure can avoid serious leaking of the medium and prevent the fire from scaling up.

Anti-static Structure

While operating the valve, the friction between the sphere and the base will produce static charges accumulating on the sphere. To avoid static spark, the fire-resistant device is designed to derive the accumulated static spark, charges from the sphere.

Jam and release

When the valve is close, the valve seats will stop the effluence, and the precipitate in the can be released through the releasing device.

Locking Device

A locking structure is designed on the full-open and full-close spots of manual ball valves to avoid abnormal open-and-close produced by miss-operation or unpredictable circuit vibration. On production lines of petroleum and chemicals of flammable mediums, and during the course of outdoor piping, the design is especially advantageous and practical.

Full Drift Diameter Structure and Retractive Diameter Structure

The two structure series are produced to meet different requirement of users. The passage inside diameter of full diameter ball valves is the same as that of valve pipe, which is convenient for pipe cleaning. The weight of retractive diameter ball valves is relatively lighter, but the fluid resistance is just 1/7 that of stop valves with the same caliber. Therefore, the application prospects of retractive diameter series is much better.



Trunnion type ball valve

固定式球阀

产品规格

| | | | | | |
|---------------|--|-----------------|------------------|------------------|------------------|
| 系列型号 | W(K)Q47、W(K)Q347、W(K)Q647、W(K)Q747、W(K)Q847、W(K)Q947 W(K)Q67、W(K)Q367、W(K)Q667、W(K)Q767、W(K)Q867、W(K)Q967 | | | | |
| 压力等级范围 | PN1.6 ~ 10.0MPa | | CLASS 150 ~ 1500 | | |
| 公称通径范围 | DN50 ~ 800mm | | 2" ~ 32" | | |
| 驱动方式 及适用范围 | 手柄驱动 | PN1.6 ~ 4.0MPa | PN6.4 ~ 25.0MPa | CLASS 150 ~ 300 | CLASS 400 ~ 1500 |
| | | DN50 ~ 150mm | DN50 ~ 80mm | 2" ~ 6" | 2" ~ 3" |
| | 蜗轮蜗杆 驱动 | PN1.6 ~ 4.0MPa | PN6.4 ~ 25.0MPa | CLASS 150 ~ 300 | CLASS 400 ~ 1500 |
| | | DN200 ~ 1500mm | DN100 ~ 1500mm | 8" ~ 60" | 4" ~ 60" |
| 气动 液动 | PN1.6 ~ 25.0MPa | CLASS 150 ~ 400 | CLASS 600 | CLASS 900 ~ 1500 | |
| | DN50 ~ 1000mm | 2" ~ 40" | 2" ~ 28" | 2" ~ 24" | |
| 电动 | PN1.6 ~ 25.0MPa | CLASS 150 ~ 600 | CLASS 900 ~ 1500 | | |
| | DN150 ~ 1500mm | 6" ~ 60" | 4" ~ 40" | | |

*注：本公司可根据用户要求提供产品

固定式球阀力矩表(N.m)

| 压力(MPa) | 通径(mm) | 50 | 65 | 80 | 100 | 125 | 150 | 200 | 250 | 300 | 350 | 400 | 450 | 500 | 600 | 700 | 800 |
|---------|--------|-----|-----|-----|------|------|------|------|------|------|-------|-------|-------|-------|-------|-------|-----|
| PN1.6 | 25 | 50 | 65 | 125 | 250 | 340 | 485 | 810 | 1310 | 1910 | 2860 | 4500 | 5860 | 8920 | 13320 | 24000 | |
| PN2.5 | 30 | 60 | 80 | 140 | 300 | 400 | 680 | 1140 | 1870 | 2740 | 4150 | 6500 | 7800 | 13210 | 19830 | 35420 | |
| PN4.0 | 50 | 100 | 150 | 250 | 450 | 585 | 996 | 1690 | 2800 | 4110 | 6300 | 8900 | 12000 | 20380 | 30670 | 55200 | |
| PN6.4 | 100 | 200 | 300 | 400 | 650 | 890 | 1500 | 2560 | 4290 | 6320 | 9750 | 13500 | 18660 | 31820 | 48020 | 63800 | |
| PN10.0 | 190 | 360 | 460 | 770 | 1050 | 1980 | 3280 | 5250 | 7200 | 9860 | 14500 | 19600 | 29000 | 42500 | 58000 | 82000 | |

*注：表中所列数据未经实际测定，仅供参考。

| 压力Class | 通径(in) | 2 | 2 1/2 | 3 | 4 | 5 | 6 | 8 | 10 | 12 | 14 | 16 | 18 | 20 | 24 | 28 | 32 | 36 | 40 |
|---------|--------|-----|-------|-----|------|------|------|------|------|------|-------|-------|-------|-------|-------|-------|-------|--------|----|
| 150 | 25 | 50 | 65 | 125 | 250 | 410 | 700 | 1100 | 1750 | 2600 | 3900 | 6200 | 7500 | 10500 | 14500 | 21000 | 28000 | 35000 | |
| 300 | 60 | 120 | 160 | 280 | 600 | 950 | 1550 | 2000 | 3300 | 5000 | 7500 | 11800 | 14400 | 19600 | 28200 | 39800 | 40000 | 45000 | |
| 400 | 140 | 240 | 350 | 540 | 740 | 1260 | 1910 | 3250 | 5340 | 7500 | 10000 | 12400 | 18500 | 29500 | 40500 | 53000 | 51000 | 71000 | |
| 600 | 190 | 360 | 460 | 770 | 1050 | 1980 | 3280 | 5250 | 7200 | 9860 | 14500 | 19600 | 29000 | 42500 | 58000 | 62000 | 75000 | 105000 | |

*注：表中所列数据未经实际测定，仅供参考。

Trunnion type ball valve

固定式球阀

Trunnion type ball valve

固定式球阀

Products specification

| Serial Model | W(K)047, W(K)0347, W(K)0647, W(K)0747, W(K)0847, W(K)0947 W(K)067, W(K)0367, W(K)0667, W(K)0767, W(K)0867, W(K)0967 | | | | |
|---|--|-----------------|------------------|------------------|------------------|
| Pressure Grade Range | PN1.6 - 10.0MPa | | CLASS 150 - 1500 | | |
| Nominal size | DN50 - 800mm | | 2" - 32" | | |
| Driving Manner and Scope of Application | Handle driving | PN1.6 - 4.0MPa | PN6.4 - 25.0MPa | CLASS 150 - 300 | CLASS 400 - 1500 |
| | | DN50 - 150mm | DN50 - 80mm | 2" - 6" | 2" - 3" |
| | Worm gear operated | PN1.6 - 4.0MPa | PN6.4 - 25.0MPa | CLASS 150 - 300 | CLASS 400 - 1500 |
| | | DN200 - 1500mm | DN100 - 1500mm | 8" - 60" | 4" - 60" |
| | Air-operating and fluid driving | PN1.6 - 25.0MPa | CLASS 150 - 400 | CLASS 600 | CLASS 900 - 1500 |
| DN50 - 1000mm | | 2" - 40" | 2" - 28" | 2" - 24" | |
| Electric Driving | PN1.6 - 25.0MPa | | CLASS 150 - 600 | CLASS 900 - 1500 | |
| | DN150 - 1500mm | | 6" - 60" | 4" - 40" | |

* Notes: our company can provide products at customer's requirement.

Trunnion type ball valve torque form(N.m)

| Pressure (Mpa) | Size (mm) | 50 | 65 | 80 | 100 | 125 | 150 | 200 | 250 | 300 | 350 | 400 | 450 | 500 | 600 | 700 | 800 |
|----------------|-----------|-----|-----|-----|------|------|------|------|------|------|-------|-------|-------|-------|-------|-------|-----|
| PN1.6 | 25 | 50 | 65 | 125 | 250 | 340 | 485 | 810 | 1310 | 1910 | 2860 | 4500 | 5860 | 8920 | 13320 | 24000 | |
| PN2.5 | 30 | 60 | 80 | 140 | 300 | 400 | 680 | 1140 | 1870 | 2740 | 4150 | 6500 | 7800 | 13210 | 19830 | 35420 | |
| PN4.0 | 50 | 100 | 150 | 250 | 450 | 585 | 996 | 1690 | 2800 | 4110 | 6300 | 8900 | 12000 | 20380 | 30670 | 55200 | |
| PN6.4 | 100 | 200 | 300 | 400 | 650 | 890 | 1500 | 2560 | 4290 | 6320 | 9750 | 13500 | 18660 | 31820 | 48020 | 63800 | |
| PN10.0 | 190 | 360 | 460 | 770 | 1050 | 1980 | 3280 | 5250 | 7200 | 9860 | 14500 | 19600 | 29000 | 42500 | 58000 | 82000 | |

* Notes: The data in the form are not practically mensurated, and just for reference.

| Class | NPS(in) | 2 | 2 1/2 | 3 | 4 | 5 | 6 | 8 | 10 | 12 | 14 | 16 | 18 | 20 | 24 | 28 | 32 | 36 | 40 |
|-------|---------|-----|-------|-----|------|------|------|------|------|------|-------|-------|-------|-------|-------|-------|-------|--------|----|
| 150 | 25 | 50 | 65 | 125 | 250 | 410 | 700 | 1100 | 1750 | 2600 | 3900 | 6200 | 7500 | 10500 | 14500 | 21000 | 28000 | 35000 | |
| 300 | 60 | 120 | 160 | 280 | 600 | 950 | 1550 | 2000 | 3300 | 5000 | 7500 | 11800 | 14400 | 19600 | 28200 | 39000 | 49000 | 60000 | |
| 400 | 140 | 240 | 350 | 540 | 740 | 1260 | 1910 | 3250 | 5340 | 7500 | 10000 | 12400 | 18500 | 29500 | 40500 | 53000 | 61000 | 71000 | |
| 600 | 190 | 360 | 460 | 770 | 1050 | 1980 | 3280 | 5250 | 7200 | 9860 | 14500 | 19600 | 29000 | 42500 | 58000 | 62000 | 75000 | 105000 | |

* Notes: The data in the form are not practically mensurated, and just for reference.

球阀流量系数Cv值 Ball valve flow coefficient Cv valve specification

| 尺寸 Size | | 压力等级 Pressure Class | | | | |
|---------|-------|---------------------|--------|--------|-------|-------|
| mm | in | 150 | 300 | 600 | 900 | 1500 |
| 15 | 1/2 | 25 | 25 | 20 | 16 | 16 |
| 20 | 3/4 | 56 | 56 | 4 | 34 | 34 |
| 25 | 1 | 95 | 95 | 64 | 55 | 55 |
| 40 | 1 1/2 | 308 | 308 | 308 | 165 | 165 |
| 50 | 2 | 500 | 430 | 370 | 320 | 320 |
| 80 | 3 | 1360 | 1100 | 1020 | 920 | 820 |
| 100 | 4 | 2500 | 2000 | 1850 | 1760 | 1600 |
| 150 | 6 | 4060 | 4056 | 3410 | 4300 | 4150 |
| 200 | 8 | 8090 | 7720 | 6730 | 8475 | 8010 |
| 250 | 10 | 13510 | 13090 | 11120 | 14160 | 13220 |
| 300 | 12 | 20440 | 19830 | 17440 | 21200 | 18800 |
| 350 | 14 | 25050 | 23770 | 22010 | 26700 | 24180 |
| 400 | 16 | 34200 | 32595 | 29980 | 36600 | 33150 |
| 450 | 18 | 44430 | 43200 | 39520 | 49000 | 45703 |
| 500 | 20 | 57665 | 55380 | 50450 | 64600 | 60750 |
| 550 | 22 | 70080 | 70080 | 68900 | | |
| 600 | 24 | 87680 | 84720 | 76630 | | |
| 700 | 28 | 120000 | 115350 | 107510 | | |
| 750 | 30 | 141850 | 136600 | 125630 | | |
| 800 | 32 | 160390 | 152200 | 140900 | | |
| 900 | 36 | 205450 | 192995 | 175730 | | |
| 1000 | 40 | 248700 | 248700 | 239160 | | |
| 1050 | 42 | 275260 | 275260 | | | |
| 1200 | 48 | 364180 | 364180 | 347080 | | |
| 1400 | 56 | 529430 | 529430 | 520500 | | |

* Note:

1. 所有尺寸都是全通径;
2. 压力等级都符合API 6D

Note:

- 1.All the sizes are in full port.
- 2.Pressure Ratings are according to API 6D.

计算流量系数的方法:

流量系数Cv值是指水通过一个全开且其压力降为1PSI的阀门时的流量(加仑/分钟)。使用以下公式可计算Cv值:

流体的流量:

$QL = Cv(P/G)^{1/2}$
 QL: 液体的流量(加仑/分钟);
 P: 通过阀门的压力差;
 G: 指定液体的比重(水: G=1);

气体流量:

$Qg = 61Cv(P_2/P_1)^{1/2}$
 (对于非临界流体: $P_2/P_1 < 1$)
 QL: 气体的流量(CFH at STP);
 P₂: 出口压力(psia);
 G: 指定气体的比重(空气: g=1.0).

Method of Calculation Flow

The Flow Coefficient Cv of a valve is the flow rate of water(gallons/minute)through a fully opened valve with a pressure drop of 1 psi across the valve.To find the flow of liquid through the valve from the Cv, use the following formulas.

Liquid Flow

$QL = Cv(P/G)^{1/2}$ QL=Flow rate of liquid(gal./min.)
 P=differential pressure across the valve(psig)
 G=specific gravity of liquid(for water, G=1)

Gas Flow

$Qg = 61Cv(P_2/P_1)^{1/2}$ (For non-critical flow, $P_2/P_1 < 1.0$)
 QL=Flow rate of gas(CFH at STP)
 P₂=outlet pressure(psia)
 G=specific gravity of gas(for air, g=1.0)

Flanged connection forged steel trunnion type ball valve

法兰连接固定式锻钢球阀

W(K)Q(3、6、7、8、9)47F(N、P)

主要零件材质

Form of Major Parts Materials

| 序号 No. | 零件名称 Part name | 材质 Material | |
|-----------|-------------------------------|--------------------------------------|--------------------------------------|
| | | GB | ASTM |
| 1 | O型圈 O-Ring | 氟橡胶 Viton | 氟橡胶 Viton |
| 2 | 密封圈 Sealing ring | PTFE | PTFE |
| 3 | 弹簧** Spring | 25 | A105 |
| 4 | 弹簧 Spring | 60Si2Mn | Inconel X-750 |
| 5 | 螺栓 Bolt | 35CrMoA | A193-B7 |
| 6 | 左右体 Bonnet | 25 | A105 |
| 7 | 注脂阀 Grease injection valve | 组合件 Assembled | 组合件 Assembled |
| 8 | 垫片 Gasket | 柔性石墨+不锈钢 Graphite+stainless steel | 柔性石墨+不锈钢 Graphite+stainless steel |
| 9 | 下阀杆** Stem** | 1Cr13 | A182-F6a |
| 10 | 垫片 Gasket | 柔性石墨+不锈钢 Graphite+stainless steel | 柔性石墨+不锈钢 Graphite+stainless steel |
| 11 | 衬套 Bushing | PTFE&镍青铜 PTFE&Nickelium | PTFE&镍青铜 PTFE&Nickelium |
| 12 | 阀体 Body | 25 | A105 |
| 13 | 球体** Ball** | 25+ENP | A105+ENP |
| 14 | 衬套 Bushing | PTFE&镍青铜 PTFE&Nickelium | PTFE&镍青铜 PTFE&Nickelium |
| 15 | 上阀杆** Stem** | 1Cr13 | A182-F6a |
| 16 | 垫片 Gasket | 柔性石墨+不锈钢 Graphite+stainless steel | 柔性石墨+不锈钢 Graphite+stainless steel |
| 17 | 阀盖 Cover | 25 | A105 |
| 18 | 填料 Packing | 柔性石墨 Flexible Graphite | 柔性石墨 Flexible Graphite |
| 19 | 支架 Yoke | WCB | A216-WCB |
| 20 | 驱动装置 Driving | 组合件 Assembled | 组合件 Assembled |
| 21 | 连接套 Connection set | 45 | AISI C1045 |
| 22 | 填料压盖 Gland | WCB | A216-WCB |
| 23 | 定位销 Fitting pin | 1Cr13 | A276-410 |
| 24 | 排污堵头 Blow-down stopple | 25 | A105 |

注：*抗硫型阀门该零件的材质为GB(1Cr18Ni9)、ASTM(A276-321)
**抗硫型阀门该零件的材质为GB(1Cr18Ni9、CF8+Ni.P)、ASTM(A182-304、CF8+Ni.P)

系列阀门主要零部件及密封面的材质可根据实际工况条件或用户特殊要求设计选用。

Notes: * The material of this part about the anti-sulphur type valve is GB(1Cr18Ni9) ASTM(A276-321)

** The material of this part about the anti-sulphur type valve is GB(1Cr18Ni9, CF8+Ni.P), ASTM(182-304, CF8+Ni.P)
Major parts of the valve series and materials of sealing surface differ according to actual working condition and customer's special requirement.

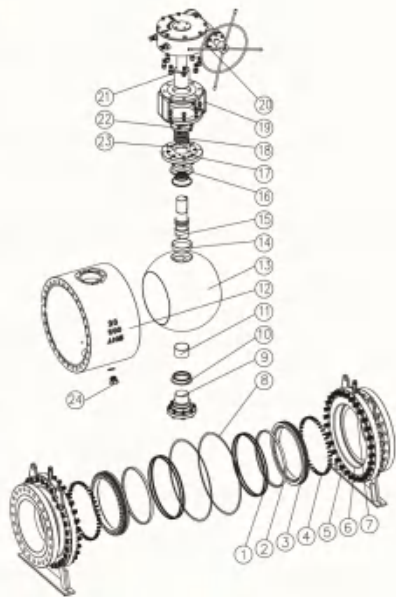

技术规范 Technical specification

| 设计标准 | GB/T 12237 | GB/T 19672 | API 6D |
|-------|------------|------------|------------------------|
| 结构长度 | GB/T 12221 | API 6D | ASME B16.10 |
| 法兰尺寸 | GB/T 9113 | JB/T 79 | ASME B16.5 ASME B16.47 |
| 检查与试验 | JB/T 9092 | GB/T 19672 | API 598 API 6D |

* 注：1、系列阀门连接法兰端尺寸可根据用户要求设计制造。
2、DN > 1000(40")阀门设计标准按《长输管线阀门技术条件》
* Notes: 1. The sizes of serial valve connecting flange ends can be designed according to customer's requirement.
2. DN > 1000(40"), the design standard is accordance with 《Specification of the long pipe valve》

Butt-weld connection forged steel trunnion type ball valve

对焊连接固定式锻钢球阀

W(K)Q(3、6、7、8、9)67F(N、P)

主要零件材质

Form of Major Parts Materials

| 序号 No. | 零件名称 Part name | 材质 Material | |
|-----------|-------------------------------|--------------------------------------|--------------------------------------|
| | | GB | ASTM |
| 1 | O型圈 O-Ring | 氟橡胶 Viton | 氟橡胶 Viton |
| 2 | 密封圈 Sealing ring | PTFE | PTFE |
| 3 | 弹簧** Spring | 25 | A105 |
| 4 | 弹簧 Spring | 60Si2Mn | Inconel X-750 |
| 5 | 螺栓 Bolt | 35CrMoA | A193-B7 |
| 6 | 左右体 Bonnet | 25 | A105 |
| 7 | 注脂阀 Grease injection valve | 组合件 Assembled | 组合件 Assembled |
| 8 | 垫片 Gasket | 柔性石墨+不锈钢 Graphite+stainless steel | 柔性石墨+不锈钢 Graphite+stainless steel |
| 9 | 下阀杆** Stem** | 1Cr13 | A182-F6a |
| 10 | 垫片 Gasket | 柔性石墨+不锈钢 Graphite+stainless steel | 柔性石墨+不锈钢 Graphite+stainless steel |
| 11 | 衬套 Bushing | PTFE&镍青铜 PTFE&Nickelium | PTFE&镍青铜 PTFE&Nickelium |
| 12 | 阀体 Body | 25 | A105 |
| 13 | 球体** Ball** | 25+ENP | A105+ENP |
| 14 | 衬套 Bushing | PTFE&镍青铜 PTFE&Nickelium | PTFE&镍青铜 PTFE&Nickelium |
| 15 | 上阀杆** Stem** | 1Cr13 | A182-F6a |
| 16 | 垫片 Gasket | 柔性石墨+不锈钢 Graphite+stainless steel | 柔性石墨+不锈钢 Graphite+stainless steel |
| 17 | 阀盖 Cover | 25 | A105 |
| 18 | 填料 Packing | 柔性石墨 Flexible Graphite | 柔性石墨 Flexible Graphite |
| 19 | 支架 Yoke | WCB | A216-WCB |
| 20 | 驱动装置 Driving | 组合件 Assembled | 组合件 Assembled |
| 21 | 连接套 Connection set | 45 | AISI C 1045 |
| 22 | 填料压盖 Gland | WCB | A216-WCB |
| 23 | 定位销 Fitting pin | 1Cr13 | A276-410 |
| 24 | 排污堵头 Blow-down stopple | 25 | A105 |

注：*抗硫型阀门该零件的材质为GB(1Cr18Ni9)、ASTM(A276-321)
**抗硫型阀门该零件的材质为GB(1Cr18Ni9、CF8+Ni.P)、ASTM(A182-304、CF8+Ni.P)

系列阀门主要零部件及密封面的材质可根据实际工况条件或用户特殊要求设计选用。

Notes: * The material of this part about the anti-sulphur type valve is GB(1Cr18Ni9) ASTM(A276-321)

** The material of this part about the anti-sulphur type valve is GB(1Cr18Ni9, CF8+Ni.P), ASTM(182-304, CF8+Ni.P)
Major parts of the valve series and materials of sealing surface differ according to actual working condition and customer's special requirement.

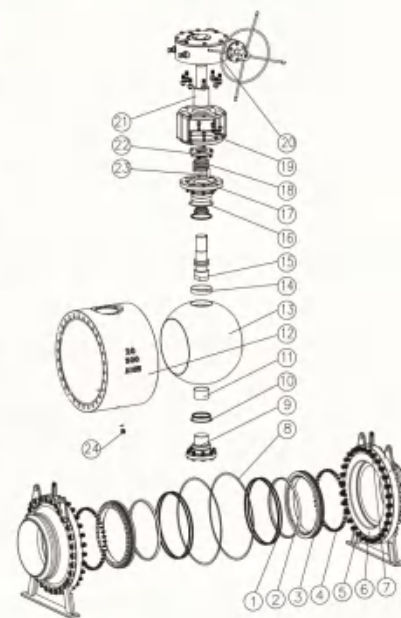

技术规范 Technical specification

| 设计标准 | GB/T 12237 | GB/T 19672 | API 6D |
|-------|------------|------------|------------------------|
| 结构长度 | GB/T 12221 | API 6D | ASME B16.10 |
| 法兰尺寸 | GB/T 9113 | JB/T 79 | ASME B16.5 ASME B16.47 |
| 检查与试验 | JB/T 9092 | GB/T 19672 | API 598 API 6D |

* 注：1、系列阀门连接法兰端尺寸可根据用户要求设计制造。
2、DN > 1000(40")阀门设计标准按《长输管线阀门技术条件》
* Notes: 1. The sizes of serial valve connecting flange ends can be designed according to customer's requirement.
2. DN > 1000(40"), the design standard is accordance with 《Specification of the long pipe valve》

Welded structure trunnion type ball valve

全焊接结构固定式球阀

W(K)Q(3、6、7、8、9)67F(N、P)

Flange structure trunnion type ball valve

法兰结构固定式球阀

W(K)Q(3、6、7、8、9)47F(N、P)

主要零件材质 Form of Major Parts Materials

| 序号 No. | 零件名称 Part name | 材质 Material | |
|-----------|------------------------------------|----------------------------|----------------------------|
| | | GB | ASTM |
| 1 | 衬套 Sleeve | 镍青铜+PTFE Nickelium+PTFE | 镍青铜+PTFE Nickelium+PTFE |
| 2 | 螺钉 Machine screw | Z5 | A105 |
| 3 | 弹簧 Spring | 60Si2Mn | Inconel X-750 |
| 4 | 阀体 Body | Z5 | A105 |
| 5 | 螺栓 Bolt | 35CrMoA | A193-B7 |
| 6 | 球体** Ball** | WCB+ENP | A216-WCB+ENP |
| 7 | 阀座** Seat** | Z5 | A105 |
| 8 | 密封圈 Sealing ring | PTFE | PTFE |
| 9 | 碟簧 Dish spring | 60Si2Mn | AISI 9260 |
| 10 | 阀座密封装置 Device for seat rotating | 组合作 Assembled | |
| 11 | 阀杆密封圈 Sealing ring for stem | PTFE | PTFE |
| 12 | 衬套 Sleeve | 镍青铜+PTFE Nickelium+PTFE | 镍青铜+PTFE Nickelium+PTFE |
| 13 | 上阀杆** Stem** | 1Cr13 | A182-F6a |
| 14 | 连接套 Connection set | 45 | AISI C 1045 |
| 15 | 驱动机构 Driving | 组合作 Assembled | |

注：“抗硫型”球阀零件的材质为GB(1Cr18Ni9)、ASTM(A276-321)
 “抗硫型”球阀零件的材质为GB(1Cr18Ni9、CF8+Ni.P)、
 ASTM(A182-304、CF8+Ni.P)

系列球阀主要零件及密封面的材质可根据实际工况条件或用户特殊要求设计选用。

Notes: * The material of this part about the anti-sulphur type valve is GB(1Cr18Ni9) ASTM(A276-321)

** The material of this part about the anti-sulphur type valve is GB(1Cr18Ni9、CF8+Ni.P)、ASTM(A182-304、CF8+Ni.P)

Major parts of the valve series and materials of sealing surface differ according to actual working condition and customer's special requirement.

技术规范 Technical specification

| 设计标准 | GB/T 12237、GB/T 19672 | API 6D |
|-------|-----------------------|------------------------|
| 结构长度 | GB/T 12221 | API 6D、ASME B16.10 |
| 法兰尺寸 | GB/T 9113、JB/T 79 | ASME B16.5、ASME B16.47 |
| 检查与试验 | JB/T 9092、GB/T 19672 | API 598、API 6D |

* 注：1、系列阀门连接法兰端尺寸可根据用户要求设计制造。
 2、DN > 1000(40")阀门设计标准按《长输管线阀门技术条件》

* Notes: 1. The sizes of serial valve connecting flange ends can be designed according to customer's requirement.
 2. DN > 1000(40"), the design standard is accordance with 《Specification of the length pipe valve》



主要零件材质 Form of Major Parts Materials

| 序号 No. | 零件名称 Part name | 材质 Material | |
|-----------|------------------------------------|----------------------------|----------------------------|
| | | GB | ASTM |
| 1 | 衬套 Sleeve | 镍青铜+PTFE Nickelium+PTFE | 镍青铜+PTFE Nickelium+PTFE |
| 2 | 螺钉 Machine screw | Z5 | A105 |
| 3 | 弹簧 Spring | 60Si2Mn | Inconel X-750 |
| 4 | 阀体 Body | Z5 | A105 |
| 5 | 螺栓 Bolt | 35CrMoA | A193-B7 |
| 6 | 球体** Ball** | WCB+ENP | A216-WCB+ENP |
| 7 | 阀座** Seat** | Z5 | A105 |
| 8 | 密封圈 Sealing ring | PTFE | PTFE |
| 9 | 碟簧 Dish spring | 60Si2Mn | AISI 9260 |
| 10 | 阀座密封装置 Device for seat rotating | 组合作 Assembled | |
| 11 | 阀杆密封圈 Sealing ring for stem | PTFE | PTFE |
| 12 | 衬套 Sleeve | 镍青铜+PTFE Nickelium+PTFE | 镍青铜+PTFE Nickelium+PTFE |
| 13 | 上阀杆** Stem** | 1Cr13 | A182-F6a |
| 14 | 连接套 Connection set | 45 | AISI C 1045 |
| 15 | 驱动机构 Driving | 组合作 Assembled | |

注：“抗硫型”球阀零件的材质为GB(1Cr18Ni9)、ASTM(A276-321)
 “抗硫型”球阀零件的材质为GB(1Cr18Ni9、CF8+Ni.P)、
 ASTM(A182-304、CF8+Ni.P)

系列球阀主要零件及密封面的材质可根据实际工况条件或用户特殊要求设计选用。

Notes: * The material of this part about the anti-sulphur type valve is GB(1Cr18Ni9) ASTM(A276-321)

** The material of this part about the anti-sulphur type valve is GB(1Cr18Ni9、CF8+Ni.P)、ASTM(A182-304、CF8+Ni.P)

Major parts of the valve series and materials of sealing surface differ according to actual working condition and customer's special requirement.

技术规范 Technical specification

| 设计标准 | GB/T 12237、GB/T 19672 | API 6D |
|-------|-----------------------|------------------------|
| 结构长度 | GB/T 12221 | API 6D、ASME B16.10 |
| 法兰尺寸 | GB/T 9113、JB/T 79 | ASME B16.5、ASME B16.47 |
| 检查与试验 | JB/T 9092、GB/T 19672 | API 598、API 6D |

* 注：1、系列阀门连接法兰端尺寸可根据用户要求设计制造。
 2、DN > 1000(40")阀门设计标准按《长输管线阀门技术条件》

* Notes: 1. The sizes of serial valve connecting flange ends can be designed according to customer's requirement.
 2. DN > 1000(40"), the design standard is accordance with 《Specification of the length pipe valve》



Cast steel trunnion type ball valve

固定式铸钢球阀

W(K)Q(3、6、7、8、9)4(6)7F(Y、N、P)

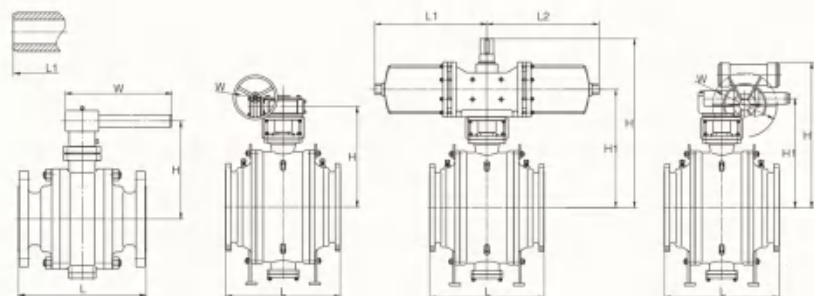

尺寸及重量 Size and weight

PN1.6MPa CLASS 150

| DN | mm | 50 | 65 | 80 | 100 | 125 | 150 | 200 | 250 | 300 | 350 | 400 | 450 | 500 | 600 | 700 | 800 | 900 | 1000 | 1050 | 1200 | 1400 | 1500 |
|---------------------------|----|------|-------|------|-----|------|-------|-------|-----|-----|------|------|------|------|------|------|-------|-------|-------|-------|-------|------|------|
| NPS | in | 2 | 2 1/2 | 3 | 4 | 5 | 6 | 8 | 10 | 12 | 14 | 16 | 18 | 20 | 24 | 28 | 32 | 36 | 40 | 42 | 48 | 58 | 60 |
| 法兰 Flange | L | 178 | 191 | 203 | 229 | 356 | 394 | 457 | 533 | 610 | 686 | 762 | 864 | 914 | 1067 | 1245 | 1372 | 1524 | 1721 | 1829 | 2180 | 2300 | 2400 |
| 对焊 Butt Welding | L1 | 216 | 241 | 283 | 305 | 381 | 457 | 521 | 559 | 635 | 762 | 838 | 914 | 991 | 1143 | 1346 | 1524 | 1727 | 1930 | 1689 | 2100 | 2250 | 2400 |
| 手动 Hand-Operated | H | 107 | 125 | 152 | 178 | 300 | 330 | - | - | - | - | - | - | - | - | - | - | - | - | - | - | - | - |
| | W | 230 | 400 | 400 | 450 | 700 | 750 | - | - | - | - | - | - | - | - | - | - | - | - | - | - | - | - |
| | kg | 9.5 | 15 | 19 | 33 | 58 | 93 | - | - | - | - | - | - | - | - | - | - | - | - | - | - | - | - |
| 蜗轮蜗杆传动 Worm Gear Operated | H | - | - | - | - | 398 | 495 | 580 | 625 | 670 | 698 | 840 | 1050 | 1100 | 1150 | 1230 | 1320 | 1480 | 1610 | 1780 | 1865 | - | - |
| | W | - | - | - | - | 600 | 600 | 800 | 800 | 800 | 800 | 800 | 800 | 800 | 800 | 800 | 800 | 800 | 800 | 800 | 800 | 800 | 800 |
| | kg | - | - | - | - | 160 | 180 | 240 | 390 | 510 | 750 | 1190 | 2600 | 3000 | 4490 | 7800 | 12560 | 14280 | 21900 | 34100 | 46200 | - | - |
| 气动 Air-Operating | H | 269 | 379 | 389 | 479 | 552 | 666 | 804 | 839 | 972 | 1127 | 1459 | 1529 | 1559 | 1145 | 1160 | 1460 | 1540 | 1630 | - | - | - | - |
| | H1 | 174 | 248 | 258 | 322 | 395 | 457 | 595 | 630 | 728 | 883 | 1154 | 1224 | 1294 | 915 | 930 | 1100 | 1180 | 1280 | - | - | - | - |
| | kg | 16.6 | 38 | 42.1 | 53 | 95.3 | 105.2 | 207.8 | 255 | 409 | 518 | 838 | 1067 | 1295 | 2330 | 3200 | 4750 | 8200 | 13200 | - | - | - | - |
| 电动 Electric Driving | H | - | - | - | - | 554 | 600 | 652 | 761 | 771 | 831 | 943 | 1123 | 1218 | 1328 | 1696 | 1925 | 2105 | 2245 | 2395 | 2470 | - | - |
| | H1 | - | - | - | - | 337 | 382 | 435 | 480 | 520 | 580 | 670 | 770 | 850 | 945 | 1055 | 1130 | 1240 | 1420 | 1560 | 1710 | 1785 | - |
| | kg | - | - | - | - | 200 | 200 | 200 | 280 | 280 | 280 | 305 | 305 | 305 | 400 | 400 | 460 | 460 | 600 | 600 | 600 | 600 | 600 |

Cast steel trunnion type ball valve

固定式铸钢球阀

W(K)Q(3、6、7、8、9)4(6)7F(Y、N、P)

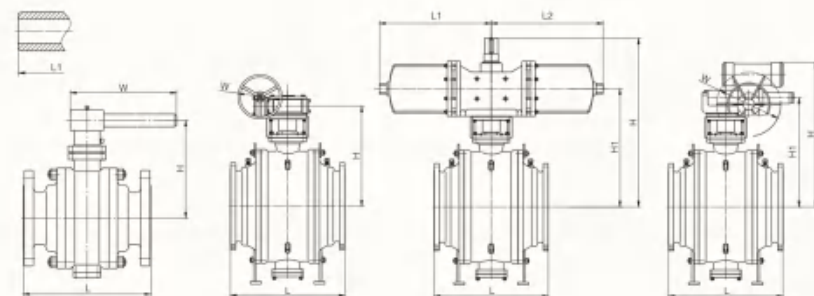

尺寸及重量 Size and weight

PN2.5、4.0MPa CLASS 300

| DN | mm | 50 | 65 | 80 | 100 | 125 | 150 | 200 | 250 | 300 | 350 | 400 | 450 | 500 | 600 | 700 | 800 | 900 | 1000 | 1050 | 1200 | 1400 | 1500 |
|---------------------------|----|------|-------|------|------|-----|-----|-----|-----|-----|------|------|------|------|------|------|-------|-------|-------|-------|-------|------|------|
| NPS | in | 2 | 2 1/2 | 3 | 4 | 5 | 6 | 8 | 10 | 12 | 14 | 16 | 18 | 20 | 24 | 28 | 32 | 36 | 40 | 42 | 48 | 58 | 60 |
| 法兰 Flange | L | 216 | 241 | 283 | 305 | 381 | 403 | 502 | 568 | 648 | 762 | 838 | 914 | 991 | 1143 | 1346 | 1524 | 1727 | 2083 | 2050 | 2180 | 2300 | 2400 |
| 对焊 Butt Welding | L1 | 216 | 241 | 283 | 305 | 381 | 457 | 521 | 559 | 635 | 762 | 838 | 914 | 991 | 1143 | 1346 | 1524 | 1727 | 2083 | 1960 | 2020 | 2250 | 2400 |
| 手动 Hand-Operated | H | 107 | 125 | 152 | 178 | 300 | 330 | - | - | - | - | - | - | - | - | - | - | - | - | - | - | - | - |
| | W | 230 | 400 | 400 | 450 | 700 | 700 | 800 | - | - | - | - | - | - | - | - | - | - | - | - | - | - | - |
| | kg | 20.9 | 42.5 | 52.9 | 92 | 145 | 182 | - | - | - | - | - | - | - | - | - | - | - | - | - | - | - | - |
| 蜗轮蜗杆传动 Worm Gear Operated | H | - | - | - | - | 398 | 495 | 580 | 625 | 670 | 698 | 840 | 1050 | 1100 | 1150 | 1230 | 1320 | 1480 | 1610 | 1780 | 1865 | - | - |
| | W | - | - | - | - | 600 | 600 | 800 | 800 | 800 | 800 | 800 | 800 | 800 | 800 | 800 | 800 | 800 | 800 | 800 | 800 | 800 | 800 |
| | kg | - | - | - | - | 160 | 180 | 240 | 390 | 510 | 750 | 1190 | 2600 | 3000 | 4490 | 7800 | 12560 | 14280 | 21900 | 34100 | 46200 | - | - |
| 气动 Air-Operating | H | 269 | 379 | 452 | 579 | 595 | 595 | 736 | 942 | 994 | 1188 | 1280 | 1480 | 1554 | 1380 | 1430 | 1749 | 1540 | 1630 | - | - | - | - |
| | H1 | 209 | 248 | 295 | 322 | 386 | 386 | 527 | 698 | 750 | 883 | 975 | 1080 | 1154 | 930 | 980 | 1149 | 1180 | 1280 | - | - | - | - |
| | kg | 20.9 | 42.5 | 52.7 | 77.9 | 107 | 130 | 220 | 280 | 450 | 570 | 920 | 1140 | 1360 | 2460 | 3360 | 5800 | 7900 | 10200 | - | - | - | - |
| 电动 Electric Driving | H | - | - | - | - | 554 | 600 | 652 | 761 | 771 | 831 | 943 | 1123 | 1218 | 1328 | 1696 | 1925 | 2105 | 2245 | 2395 | 2470 | - | - |
| | H1 | - | - | - | - | 337 | 382 | 435 | 480 | 520 | 580 | 670 | 770 | 850 | 945 | 1055 | 1130 | 1240 | 1420 | 1560 | 1710 | 1785 | - |
| | kg | - | - | - | - | 200 | 200 | 200 | 280 | 280 | 280 | 305 | 305 | 305 | 400 | 400 | 460 | 460 | 600 | 600 | 600 | 600 | 600 |

Cast steel trunnion type ball valve

固定式铸钢球阀

W(K)Q(3、6、7、8、9)4(6)7F(Y、N、P)

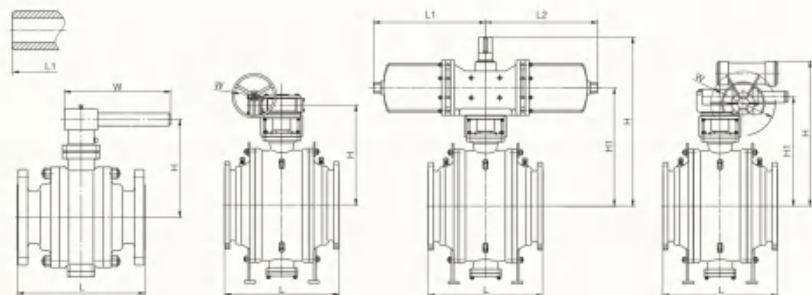

尺寸及重量 Size and weight

PN6.4MPa CLASS 400

| DN | mm | 50 | 65 | 80 | 100 | 150 | 200 | 250 | 300 | 350 | 400 | 450 | 500 | 600 | 700 | 800 | 900 | 1050 | 1050 | 1200 | 1400 | 1500 |
|--|------------|-----|-------|-----------------|-----------------|-----------------|-----------------|-----------------|-----------------|-----------------|-----------------|-----------------|-----------------|-----------------|-----------------|-----------------|-----------------|-----------------|-----------------|-----------------|-----------------|------|
| NPS | in | 2 | 2 1/2 | 3 | 4 | 6 | 8 | 10 | 12 | 14 | 16 | 18 | 20 | 24 | 28 | 32 | 36 | 40 | 42 | 48 | 56 | 60 |
| 法兰 Flange | L | 292 | 330 | 356 | 406 | 495 | 597 | 673 | 762 | 826 | 902 | 978 | 1054 | 1232 | 1397 | 1651 | 1880 | 2300 | 2057 | 2400 | 2400 | 2700 |
| 对焊 Butt Welding | L1 | 292 | 330 | 356 | 406 | 495 | 597 | 673 | 762 | 826 | 902 | 978 | 1054 | 1232 | 1397 | 1651 | 1880 | 2300 | 2050 | 2180 | 2300 | 2400 |
| 手动 Hand- Operated | H | 108 | 155 | 197 | - | - | - | - | - | - | - | - | - | - | - | - | - | - | - | - | - | - |
| | W | 230 | 400 | 400 | - | - | - | - | - | - | - | - | - | - | - | - | - | - | - | - | - | - |
| | kg | 25 | 45 | 60 | - | - | - | - | - | - | - | - | - | - | - | - | - | - | - | - | - | - |
| 蜗轮蜗 杆传动 Worm Gear Operated | H | - | - | - | 235 | 300 | 374 | 445 | 512 | 550 | 615 | 750 | 810 | 1050 | 1100 | 1180 | 1274 | 1366 | 1540 | 1680 | 1840 | 1915 |
| | W | - | - | - | 600 | 600 | 800 | 800 | 800 | 800 | 800 | 800 | 800 | 800 | 800 | 800 | 800 | 800 | 1000 | 1000 | 1000 | 1000 |
| | 型号 Type | - | - | - | B | C | C | C | D | D | DA | DA | DB | DC | DD | DD | DH | DH | DI | DI | DK | DK |
| kg | - | - | - | 66 | 145 | 250 | 540 | 780 | 1000 | 1300 | 2100 | 3400 | 5000 | 6520 | 8350 | 11250 | 14100 | 72500 | 29500 | 42100 | 62500 | |
| 气动 Air- Operating | H | 269 | - | 519 | 636 | 728 | 839 | 1014 | 1120 | 1225 | 1480 | - | 1480 | 1365 | 1430 | - | - | - | - | - | - | - |
| | H1 | 209 | - | 295 | 322 | 386 | 527 | 698 | 750 | 883 | 1080 | - | 1080 | 915 | 980 | - | - | - | - | - | - | - |
| | L1 | 148 | - | 287 | 287 | 378 | 378 | 530 | 530 | 680 | 680 | - | 680 | 1665 | 1665 | - | - | - | - | - | - | - |
| L2 | 257 | - | 287 | 287 | 378 | 378 | 530 | 530 | 680 | 680 | - | 680 | 1665 | 1665 | - | - | - | - | - | - | - | |
| 型号 Type | AG13 | - | AW13 | AW13 | AW17 | AW20 | AW20 | AW28 | AW28 | C1-355 | - | C1-355 | C2-490 | C2-490 | - | - | - | - | - | - | - | |
| kg | 33.6 | - | 55.3 | 81.2 | 133.6 | 236.6 | 480 | 760 | 1050 | 1400 | - | 2300 | 3600 | 5200 | - | - | - | - | - | - | - | |
| 电动 Electric Driving | H | - | - | - | 554 | 600 | 652 | 761 | 771 | 831 | 921 | 943 | 1123 | 1218 | 1328 | 1615 | 1925 | 2164 | 2324 | 2474 | 2544 | |
| | H1 | - | - | - | 337 | 382 | 480 | 520 | 594 | 632 | 670 | 770 | 850 | 945 | 1055 | 1130 | 1240 | 1440 | 1660 | 1750 | 1820 | |
| | W | - | - | - | 200 | 200 | 200 | 280 | 280 | 280 | 280 | 305 | 305 | 305 | 460 | 460 | 600 | 600 | 600 | 600 | 600 | |
| 型号 Type | - | - | - | SNE-04 +H1BC | SNE-04 +H1BC | SNE-03 +H2BC | SNE-03 +H3BC | SNE-03 +H3BC | SNE-03 +H3BC | SNE-03 +H3BC | SNE-03 +H3BC | SNE-03 +H3BC | SNE-03 +H3BC | SNE-03 +H3BC | SNE-03 +H3BC | SNE-03 +H3BC | SNE-03 +H3BC | SNE-03 +H3BC | SNE-03 +H3BC | SNE-03 +H3BC | SNE-03 +H3BC | |
| kg | - | - | - | 154 | 240 | 495 | 793 | 1125 | 1610 | 1800 | 2410 | 3750 | 5540 | 7900 | 12500 | 15300 | 18100 | 31000 | 45000 | 65200 | | |



Cast steel trunnion type ball valve

固定式铸钢球阀

W(K)Q(3、6、7、8、9)4(6)7F(Y、N、P)

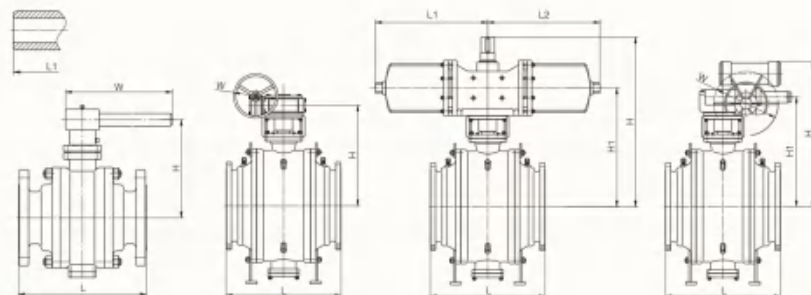

尺寸及重量 Size and weight

PN10.0MPa CLASS 600

| DN | mm | 50 | 65 | 80 | 100 | 150 | 200 | 250 | 300 | 350 | 400 | 450 | 500 | 600 | 700 | 800 | 900 | 1000 | 1050 | 1200 | 1400 | 1500 |
|--|------------|-----|-------|-----------------|-----------------|-----------------|-----------------|-----------------|-----------------|-----------------|-----------------|-----------------|-----------------|-----------------|-----------------|-----------------|-----------------|-----------------|-----------------|-----------------|-----------------|------|
| NPS | in | 2 | 2 1/2 | 3 | 4 | 6 | 8 | 10 | 12 | 14 | 16 | 18 | 20 | 24 | 28 | 32 | 36 | 40 | 42 | 48 | 56 | 60 |
| 法兰 Flange | L | 292 | 330 | 356 | 432 | 559 | 660 | 787 | 838 | 889 | 991 | 1092 | 1194 | 1397 | 1549 | 1778 | 2083 | 2337 | 2100 | 2400 | 2400 | 2700 |
| 对焊 Butt Welding | L1 | 292 | 330 | 356 | 432 | 559 | 660 | 787 | 838 | 889 | 991 | 1092 | 1194 | 1397 | 1549 | 1778 | 2083 | 2337 | 2050 | 2180 | 2300 | 2400 |
| 手动 Hand- Operated | H | 108 | 155 | 197 | - | - | - | - | - | - | - | - | - | - | - | - | - | - | - | - | - | - |
| | W | 400 | 650 | 650 | - | - | - | - | - | - | - | - | - | - | - | - | - | - | - | - | - | - |
| | kg | 31 | 54 | 62 | - | - | - | - | - | - | - | - | - | - | - | - | - | - | - | - | - | - |
| 蜗轮蜗 杆传动 Worm Gear Operated | H | - | - | - | 235 | 300 | 374 | 445 | 512 | 550 | 615 | 750 | 810 | 1050 | 1180 | 1290 | 1315 | 1420 | 1540 | 1680 | 1840 | 1915 |
| | W | - | - | - | 600 | 600 | 800 | 800 | 800 | 800 | 800 | 800 | 800 | 800 | 800 | 800 | 800 | 800 | 800 | 1000 | 1000 | 1000 |
| | 型号 Type | - | - | - | B | C | C | D | D | DA | DA | DB | DC | DD | DH | DH | DH | DH | DI | DI | DK | DK |
| kg | - | - | - | 113 | 253 | 485 | 758 | 1067 | 1083 | 1525 | 2095 | 2638 | 4736 | 6758 | 9138 | 13298 | 18335 | 21356 | 31195 | 47483 | 65200 | |
| 气动 Air- Operating | H | 269 | - | 519 | 636 | 728 | 839 | 1014 | 1120 | 1224 | 1374 | - | 1490 | 1615 | 1760 | - | - | - | - | - | - | |
| | H1 | 209 | - | 295 | 479 | 519 | 595 | 770 | 810 | 1004 | 1154 | - | 1210 | 1335 | 1440 | - | - | - | - | - | - | |
| | L1 | 148 | - | 287 | 287 | 378 | 530 | 530 | 680 | 1445 | 1445 | - | 1665 | 1665 | 1960 | - | - | - | - | - | - | |
| L2 | 257 | - | 287 | 287 | 378 | 530 | 530 | 680 | 1445 | 1445 | - | 1665 | 1665 | 1960 | - | - | - | - | - | - | | |
| 型号 Type | AG13 | - | AW13 | AW13 | AW17 | AW20 | AW20 | AW28 | AW28 | C1-355 | - | C1-355 | C2-490 | C2-490 | C3-600 | - | - | - | - | - | | |
| kg | 225 | - | 325 | 656 | 927 | 1350 | 1660 | 1820 | 2130 | 2550 | - | 3500 | 5300 | 6800 | - | - | - | - | - | | | |
| 电动 Electric Driving | H | - | - | - | 600 | 652 | 761 | 771 | 831 | 921 | 943 | 1123 | 1218 | 1328 | 1458 | 1855 | 1960 | 2164 | 2324 | 2474 | 2544 | |
| | H1 | - | - | - | 382 | 480 | 520 | 594 | 632 | 670 | 770 | 850 | 945 | 1055 | 1135 | 1170 | 1285 | 1440 | 1660 | 1750 | 1820 | |
| | W | - | - | - | 200 | 200 | 280 | 280 | 280 | 305 | 305 | 305 | 400 | 400 | 400 | 600 | 600 | 600 | 600 | 600 | 600 | |
| 型号 Type | - | - | - | SNE-04 +H1BC | SNE-04 +H1BC | SNE-03 +H2BC | SNE-03 +H3BC | SNE-03 +H3BC | SNE-03 +H3BC | SNE-03 +H3BC | SNE-03 +H3BC | SNE-03 +H3BC | SNE-03 +H3BC | SNE-03 +H3BC | SNE-03 +H3BC | SNE-03 +H3BC | SNE-03 +H3BC | SNE-03 +H3BC | SNE-03 +H3BC | SNE-03 +H3BC | SNE-03 +H3BC | |
| kg | - | - | - | 930 | 1410 | 1620 | 1910 | 2200 | 2600 | 2950 | 3620 | 5410 | 6920 | 10000 | 13420 | 18450 | 22300 | 32000 | 48000 | 66200 | | |

Cast steel trunnion type ball valve

固定式铸钢球阀

W(K)Q(3、6、7、8、9)4(6)7F(Y、N、P)

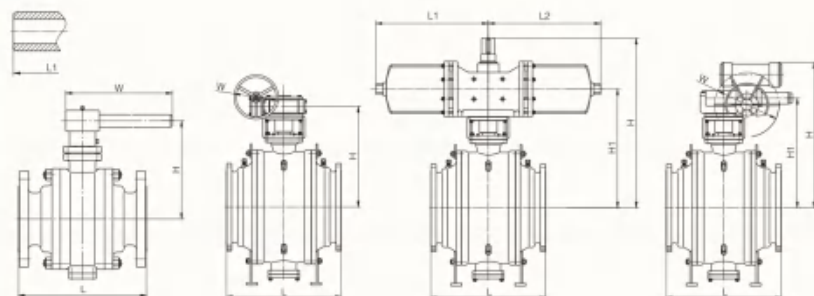

尺寸及重量 Size and weight

PN15.0MPa CLASS 900

| DN | mm | 50 | 65 | 80 | 100 | 150 | 200 | 250 | 300 | 350 | 400 | 450 | 500 | 600 | 750 | 800 | 900 | 1000 | 1200 |
|----------------------------------|----|-----|-------|-----|-----|------|------|------|-------|------|------|------|------|------|------|------|------|------|------|
| MPS | in | 2 | 2 1/2 | 3 | 4 | 6 | 8 | 10 | 12 | 14 | 15 | 18 | 20 | 24 | 30 | 32 | 36 | 40 | 48 |
| 法兰 Flange | L | 368 | 419 | 381 | 457 | 610 | 737 | 838 | 9 | 1029 | 1130 | 1219 | 1321 | 1549 | 1780 | 2050 | 2050 | 2180 | 2600 |
| 对焊 Butt Welding | L1 | 368 | 419 | 381 | 457 | 610 | 737 | 838 | 965 | 1029 | 1130 | 1219 | 1321 | 1549 | 1700 | 1780 | 1960 | 2100 | 2376 |
| 手动 Hand-Operated | H | 217 | 241 | 259 | - | - | - | - | - | - | - | - | - | - | - | - | - | - | - |
| | W | 650 | 650 | 650 | - | - | - | - | - | - | - | - | - | - | - | - | - | - | - |
| 蜗轮蜗杆 传动 Worm Gear Operated | H | - | - | - | 297 | 364 | 394 | 502 | 572 | 675 | 762 | 866 | 894 | 965 | 1210 | 1290 | 1360 | 1480 | 1630 |
| | W | - | - | - | 600 | 800 | 800 | 800 | 800 | 800 | 800 | 800 | 800 | 800 | 800 | 1000 | 1000 | 1000 | 1000 |
| 气动 Air-Operating | H | 519 | - | 728 | 842 | 1014 | 1120 | 1124 | 13747 | 1490 | 1615 | 1760 | 1760 | 1760 | - | - | - | - | - |
| | H1 | 295 | - | 519 | 595 | 770 | 815 | 1004 | 1154 | 1210 | 1335 | 1410 | 1410 | 1410 | - | - | - | - | - |
| 电动 Electric Driving | H | - | - | - | 600 | 761 | 771 | 831 | 921 | 943 | 1123 | 1218 | 1328 | 1458 | 1904 | 1984 | 2054 | 2174 | 2274 |
| | H1 | - | - | - | 382 | 520 | 594 | 632 | 670 | 770 | 850 | 946 | 1055 | 1135 | 1180 | 1260 | 1330 | 1450 | 1560 |

Cast steel trunnion type ball valve

固定式铸钢球阀

W(K)Q(3、6、7、8、9)4(6)7F(Y、N、P)

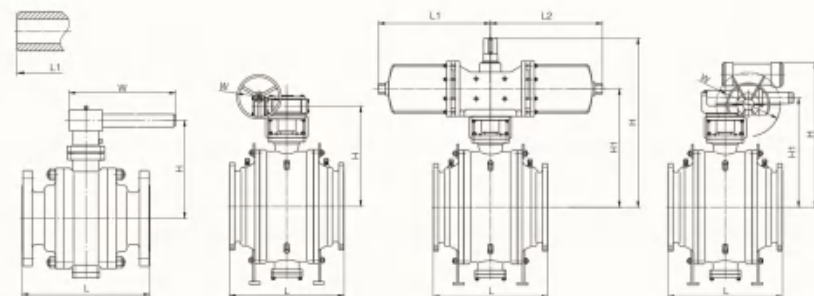

尺寸及重量 Size and weight

PN25.0MPa CLASS 1500

| DN | mm | 50 | 65 | 80 | 100 | 150 | 200 | 250 | 300 | 350 | 400 | 450 | 500 | 600 |
|----------------------------------|----|-----|-------|-----|------|------|------|------|------|------|------|------|------|------|
| MPS | in | 2 | 2 1/2 | 3 | 4 | 6 | 8 | 10 | 12 | 14 | 16 | 18 | 20 | 24 |
| 法兰 Flange | L | 368 | 419 | 470 | 546 | 705 | 832 | 991 | 1130 | 1257 | 1384 | 1537 | 1664 | 2043 |
| 对焊 Butt Welding | L1 | 368 | 419 | 470 | 546 | 705 | 832 | 991 | 1130 | 1257 | 1384 | 1537 | 1664 | 2043 |
| 手动 Hand-Operated | H | 217 | 241 | 259 | - | - | - | - | - | - | - | - | - | - |
| | W | 650 | 650 | 650 | - | - | - | - | - | - | - | - | - | - |
| 蜗轮蜗杆 传动 Worm Gear Operated | H | 217 | 241 | 259 | 297 | 364 | 475 | 578 | 696 | 761 | 831 | 900 | 950 | 1080 |
| | W | 600 | 600 | 600 | 600 | 800 | 800 | 800 | 800 | 800 | 800 | 800 | 800 | 800 |
| 气动 Air-Operating | H | 519 | 728 | 842 | 1014 | 1120 | 1124 | 1374 | 1490 | 1615 | 1760 | 1760 | 1760 | - |
| | H1 | 295 | 519 | 595 | 770 | 815 | 1004 | 1154 | 1210 | 1335 | 1410 | 1410 | 1410 | - |
| 电动 Electric Driving | H | - | - | 652 | 761 | 771 | 831 | 921 | 943 | 1123 | 1218 | 1328 | 1458 | - |
| | H1 | - | - | 480 | 520 | 594 | 632 | 670 | 770 | 850 | 945 | 1055 | 1135 | - |



Forged steel trunnion type ball valve

固定式锻钢球阀

W(K)Q(3、6、7、8、9)4(6)7F(Y、N、P)

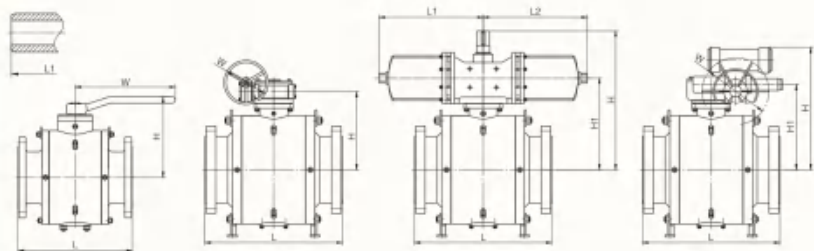

尺寸及重量 Size and weight

PN1.6MPa CLASS 150

| DN | mm | 50 | 65 | 80 | 100 | 125 | 150 | 200 | 250 | 300 | 350 | 400 | 450 | 500 | 600 | 700 | 800 | 900 | 1000 | 1050 | 1200 | 1400 | 1500 |
|---------------------------|---------|------|-------|------|--------|--------|--------|--------|--------|--------|--------|--------|--------|--------|-------|--------|--------|--------|--------|--------|-------|-------|------|
| MPS | in | 2 | 2 1/2 | 3 | 4 | 5 | 6 | 8 | 10 | 12 | 14 | 16 | 18 | 20 | 24 | 28 | 32 | 36 | 40 | 42 | 48 | 56 | 60 |
| 法兰 Flange | L | 178 | 191 | 203 | 229 | 356 | 394 | 457 | 533 | 610 | 686 | 762 | 864 | 914 | 1067 | 1245 | 1372 | 1524 | 1721 | 1829 | 2180 | 2300 | 2400 |
| 对焊 But Welding | L1 | 216 | 241 | 283 | 305 | 381 | 457 | 521 | 599 | 635 | 762 | 838 | 914 | 991 | 1143 | 1346 | 1524 | 1727 | 1930 | 1689 | 2100 | 2250 | 2400 |
| 手动 Hand-Operated | H | 130 | 142 | 191 | 200 | 226 | 242 | - | - | - | - | - | - | - | - | - | - | - | - | - | - | - | - |
| | W | 230 | 350 | 400 | 450 | 750 | 750 | - | - | - | - | - | - | - | - | - | - | - | - | - | - | - | - |
| | kg | 12 | 28 | 33 | 50 | 78 | 93 | - | - | - | - | - | - | - | - | - | - | - | - | - | - | - | - |
| 蜗轮蜗杆传动 Worm Gear Operated | H | - | - | - | - | - | 337 | 385 | 414 | 447 | 545 | 545 | 585 | 663 | 723 | 923 | 986 | 1061 | 1420 | 1530 | 1640 | 1710 | |
| | W | - | - | - | - | - | 600 | 600 | 800 | 800 | 800 | 800 | 800 | 800 | 800 | 800 | 800 | 800 | 800 | 800 | 800 | 800 | 800 |
| | 型号 Type | - | - | - | - | - | B | B | C | C | D | D | D | DA | DA | DB | DB | DC | DC | DD | DH | DH | |
| kg | - | - | - | - | - | 250 | 390 | 576 | 770 | 1100 | 1250 | 1800 | 2400 | 4500 | 6900 | 9700 | 13000 | 15000 | 23000 | 37000 | 39500 | | |
| 气动 Air-Operating | H | 269 | 379 | 389 | 479 | 552 | 666 | 769 | 824 | 897 | 937 | 1121 | 1161 | 1203 | 1145 | 1160 | 1460 | 1510 | 1610 | - | - | - | - |
| | H1 | 174 | 248 | 258 | 322 | 395 | 457 | 560 | 615 | 653 | 691 | 816 | 856 | 898 | 915 | 930 | 1100 | 1150 | 1250 | - | - | - | - |
| | L1 | 89 | 148 | 148 | 287 | 287 | 378 | 378 | 530 | 530 | 680 | 680 | 680 | 1455 | 1455 | 1665 | 1665 | 1960 | - | - | - | - | |
| L2 | 181 | 257 | 257 | 287 | 287 | 378 | 378 | 530 | 530 | 680 | 680 | 680 | 1455 | 1455 | 1665 | 1665 | 1960 | - | - | - | - | | |
| 型号 Type | AG09 | AG13 | AG13 | AW13 | AW13 | AW17 | AW17 | AW17 | AW17 | AW20 | AW20 | AW28 | AW28 | AW28 | AW28 | C1-355 | C1-355 | C2-490 | C2-490 | C3-600 | | | |
| kg | 32 | 42 | 53 | 100 | 125 | 157 | 265 | 410 | 595 | 795 | 1150 | 1295 | 1910 | 2400 | 4600 | 7100 | 10100 | 14200 | - | - | - | - | |
| 电动 Electric Driving | H | - | - | - | - | 559 | 710 | 744 | 851 | 859 | 959 | 999 | 965 | 1141 | 1233 | 1341 | 1666 | 1895 | 2114 | 2194 | 2374 | 2404 | |
| | H1 | - | - | - | - | 342 | 492 | 527 | 570 | 608 | 708 | 748 | 790 | 866 | 960 | 1068 | 1100 | 1210 | 1390 | 1470 | 1650 | 1680 | |
| | W | - | - | - | - | 200 | 200 | 200 | 280 | 280 | 280 | 305 | 305 | 305 | 400 | 400 | 460 | 460 | 600 | 600 | 600 | 600 | 600 |
| 型号 Type | - | - | - | - | SNC-04 | SNC-04 | SNC-04 | SNC-04 | SNC-03 | SNC-03 | SNC-03 | SNC-03 | SNC-03 | SNC-03 | SNC-1 | SNC-2 | SNC-3 | SNC-3 | SNC-3 | SNC-4 | SNC-4 | SNC-4 | |
| kg | - | - | - | - | 152 | 245 | 425 | 610 | 800 | 1180 | 1300 | 1200 | 2500 | 4710 | 7300 | 10200 | 15200 | 16800 | 24000 | 38500 | 40500 | | |



Forged steel trunnion type ball valve

固定式锻钢球阀

W(K)Q(3、6、7、8、9)4(6)7F(Y、N、P)

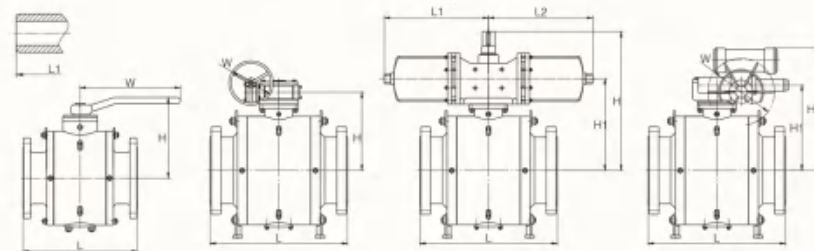

尺寸及重量 Size and weight

PN2.5、4.0MPa CLASS 300

| DN | mm | 50 | 65 | 80 | 100 | 125 | 150 | 200 | 250 | 300 | 350 | 400 | 450 | 500 | 600 | 700 | 800 | 900 | 1000 | 1050 | 1200 | 1400 | 1500 |
|---------------------------|---------|------|-------|------|--------|--------|--------|--------|--------|--------|--------|--------|--------|--------|--------|--------|-------|-------|-------|-------|-------|-------|------|
| MPS | in | 2 | 2 1/2 | 3 | 4 | 5 | 6 | 8 | 10 | 12 | 14 | 16 | 18 | 20 | 24 | 28 | 32 | 36 | 40 | 42 | 48 | 56 | 60 |
| 法兰 Flange | L | 216 | 241 | 283 | 305 | 381 | 403 | 502 | 568 | 648 | 762 | 838 | 914 | 991 | 1143 | 1346 | 1524 | 1727 | 2063 | 2050 | 2180 | 2300 | 2400 |
| 对焊 But Welding | L1 | 216 | 241 | 283 | 305 | 381 | 457 | 521 | 559 | 635 | 762 | 838 | 914 | 991 | 1143 | 1346 | 1524 | 1727 | 2063 | 1960 | 2020 | 2250 | 2400 |
| 手动 Hand-Operated | H | 136 | 164 | 191 | 223 | 240 | 253 | - | - | - | - | - | - | - | - | - | - | - | - | - | - | - | - |
| | W | 240 | 400 | 400 | 600 | 750 | 800 | - | - | - | - | - | - | - | - | - | - | - | - | - | - | - | - |
| | kg | 32 | 37 | 58 | 110 | 157 | 180 | - | - | - | - | - | - | - | - | - | - | - | - | - | - | - | - |
| 蜗轮蜗杆传动 Worm Gear Operated | H | - | - | - | - | - | 337 | 385 | 414 | 447 | 545 | 545 | 585 | 663 | 723 | 923 | 986 | 1061 | 1420 | 1530 | 1640 | 1710 | |
| | W | - | - | - | - | - | 600 | 600 | 800 | 800 | 800 | 800 | 800 | 800 | 800 | 800 | 800 | 800 | 800 | 800 | 800 | 800 | 800 |
| | 型号 Type | - | - | - | - | - | B | B | C | C | D | D | DA | DA | DB | DB | DC | DC | DD | DD | DC | DD | DH |
| kg | - | - | - | - | - | 280 | 410 | 760 | 1100 | 1600 | 1700 | 2300 | 3500 | 6000 | 8000 | 11000 | 14000 | 17000 | 25000 | 39500 | 45300 | | |
| 气动 Air-Operating | H | 360 | 388 | 476 | 418 | 621 | 634 | 701 | 771 | 814 | 913 | 1013 | 1148 | 1190 | 1316 | 1410 | 1518 | 1740 | 1850 | - | - | - | - |
| | H1 | 229 | 257 | 319 | 361 | 412 | 425 | 492 | 527 | 570 | 606 | 708 | 748 | 790 | 866 | 960 | 1068 | 1140 | 1250 | - | - | - | |
| | L1 | 148 | 148 | 287 | 287 | 378 | 378 | 530 | 530 | 680 | 680 | 680 | 1455 | 1455 | 1665 | 1665 | 1960 | 1960 | - | - | - | | |
| L2 | 181 | 257 | 287 | 287 | 378 | 378 | 530 | 530 | 680 | 680 | 680 | 1455 | 1455 | 1665 | 1665 | 1960 | 1960 | - | - | - | | | |
| 型号 Type | AG13 | AG13 | AG13 | AW13 | AW17 | AW17 | AW20 | AW20 | AW28 | AW28 | AW28 | C1-355 | C1-355 | C2-490 | C2-490 | C3-600 | | | | | | | |
| kg | 45 | 70 | 95 | 153 | 260 | 350 | 450 | 750 | 1140 | 1580 | 2550 | 2300 | 3100 | 4000 | 6000 | 8120 | 11200 | 14500 | - | - | - | | |
| 电动 Electric Driving | H | - | - | - | - | 559 | 710 | 744 | 851 | 859 | 959 | 999 | 963 | 1141 | 1233 | 1341 | 1696 | 1925 | 2114 | 2194 | 2374 | 2404 | |
| | H1 | - | - | - | - | 342 | 492 | 527 | 570 | 606 | 708 | 748 | 790 | 866 | 960 | 1068 | 1100 | 1210 | 1390 | 1470 | 1650 | 1680 | |
| | W | - | - | - | - | 200 | 200 | 200 | 280 | 280 | 280 | 305 | 305 | 305 | 400 | 400 | 460 | 460 | 600 | 600 | 600 | 600 | 600 |
| 型号 Type | - | - | - | - | SNC-04 | SNC-04 | SNC-04 | SNC-04 | SNC-03 | SNC-03 | SNC-03 | SNC-03 | SNC-03 | SNC-1 | SNC-2 | SNC-3 | SNC-3 | SNC-3 | SNC-4 | SNC-4 | SNC-4 | SNC-4 | |
| kg | - | - | - | - | 380 | 460 | 780 | 1150 | 1620 | 2160 | 2400 | 3120 | 4500 | 6100 | 8210 | 11400 | 14800 | 17500 | 26000 | 41000 | 46200 | | |

Forged steel trunnion type ball valve

固定式锻钢球阀

W(K)Q(3、6、7、8、9)4(6)7F(Y、N、P)

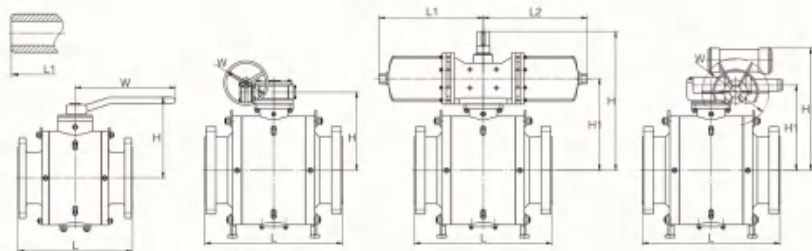

尺寸及重量 Size and weight

PN6.4MPa CLASS 400

| DN | mm | 50 | 65 | 80 | 100 | 150 | 200 | 250 | 300 | 350 | 400 | 450 | 500 | 600 | 700 | 800 | 900 | 1000 | 1050 | 1200 | 1400 | 1500 |
|---------------------------|----|-----|-------|-----|-----|-----|-----|------|------|------|------|------|------|------|------|------|-------|-------|-------|-------|-------|-------|
| NPS | in | 2 | 2 1/2 | 3 | 4 | 6 | 8 | 10 | 12 | 14 | 16 | 18 | 20 | 24 | 28 | 32 | 36 | 40 | 42 | 48 | 56 | 60 |
| 法兰 Flange | L | 292 | 330 | 356 | 406 | 495 | 597 | 673 | 762 | 826 | 902 | 978 | 1054 | 1232 | 1397 | 1651 | 1880 | 2300 | 2057 | 2400 | 2400 | 2700 |
| 对焊 Butt Welding | L1 | 292 | 330 | 356 | 406 | 495 | 597 | 673 | 762 | 826 | 902 | 978 | 1054 | 1232 | 1397 | 1651 | 1880 | 2300 | 2050 | 2180 | 2300 | 2400 |
| 手动 Hand-Operated | H | 136 | 164 | 191 | - | - | - | - | - | - | - | - | - | - | - | - | - | - | - | - | - | - |
| | W | 230 | 400 | 400 | - | - | - | - | - | - | - | - | - | - | - | - | - | - | - | - | - | - |
| | kg | 35 | 40 | 59 | - | - | - | - | - | - | - | - | - | - | - | - | - | - | - | - | - | - |
| 蜗轮蜗杆传动 Worm Gear Operated | H | - | - | - | 244 | 303 | 342 | 382 | 420 | 458 | 558 | 598 | 630 | 759 | 836 | 915 | 987 | 1212 | 1460 | 1600 | 1760 | 1845 |
| | W | - | - | - | 600 | 600 | 800 | 800 | 800 | 800 | 800 | 800 | 800 | 800 | 800 | 800 | 800 | 800 | 1000 | 1000 | 1000 | 1000 |
| | kg | - | - | - | 180 | 240 | 296 | 425 | 790 | 1210 | 1650 | 1720 | 2400 | 3560 | 6100 | 8200 | 11500 | 14500 | 17800 | 26000 | 41050 | 46200 |
| 气动 Air-Operating | H | 269 | - | 519 | 636 | 728 | 839 | 1014 | 1120 | 1225 | 1480 | - | 1480 | 1365 | 1430 | - | - | - | - | - | - | - |
| | H1 | 209 | - | 295 | 322 | 386 | 527 | 698 | 750 | 883 | 1080 | - | 1080 | 915 | 980 | - | - | - | - | - | - | - |
| | kg | 50 | - | 98 | 156 | 380 | 575 | 760 | 1150 | 1600 | 2200 | - | 3150 | 4480 | 6200 | - | - | - | - | - | - | - |
| 电动 Electric Driving | H | - | - | - | 520 | 560 | 554 | 661 | 635 | 757 | 879 | 803 | 981 | 1073 | 1133 | 1287 | 1512 | 2114 | 2254 | 2424 | 2524 | |
| | H1 | - | - | - | 303 | 342 | 382 | 420 | 458 | 558 | 598 | 630 | 759 | 836 | 915 | 987 | 1212 | 1390 | 1530 | 1700 | 1800 | |
| | kg | - | - | - | 200 | 200 | 200 | 280 | 280 | 280 | 290 | 305 | 305 | 305 | 460 | 460 | 600 | 600 | 600 | 600 | 600 | 600 |

Forged steel trunnion type ball valve

固定式锻钢球阀

W(K)Q(3、6、7、8、9)4(6)7F(Y、N、P)

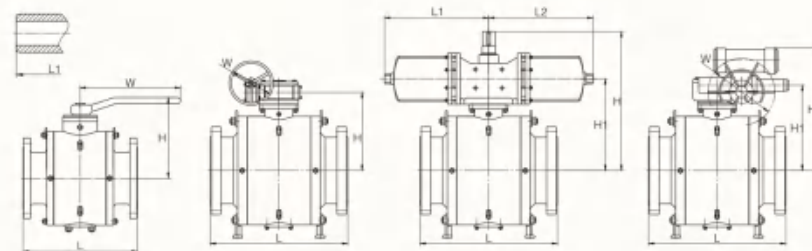

尺寸及重量 Size and weight

PN10.0MPa CLASS 600

| DN | mm | 50 | 65 | 80 | 100 | 150 | 200 | 250 | 300 | 350 | 400 | 450 | 500 | 600 | 700 | 800 | 900 | 1000 | 1050 | 1200 | 1400 | 1500 |
|---------------------------|----|-----|-------|-----|-----|-----|-----|------|------|------|------|------|------|------|------|------|-------|-------|-------|-------|-------|-------|
| NPS | in | 2 | 2 1/2 | 3 | 4 | 6 | 8 | 10 | 12 | 14 | 16 | 18 | 20 | 24 | 28 | 32 | 36 | 40 | 42 | 48 | 56 | 60 |
| 法兰 Flange | L | 292 | 330 | 356 | 432 | 559 | 660 | 787 | 838 | 889 | 991 | 1092 | 1194 | 1397 | 1549 | 1778 | 2083 | 2337 | 2100 | 2400 | 2400 | 2700 |
| 对焊 Butt Welding | L1 | 292 | 330 | 356 | 432 | 559 | 660 | 787 | 838 | 889 | 991 | 1092 | 1194 | 1397 | 1549 | 1778 | 2083 | 2337 | 2050 | 2180 | 2300 | 2400 |
| 手动 Hand-Operated | H | 136 | 164 | 191 | - | - | - | - | - | - | - | - | - | - | - | - | - | - | - | - | - | - |
| | W | 500 | 650 | 650 | - | - | - | - | - | - | - | - | - | - | - | - | - | - | - | - | - | - |
| | kg | 35 | 42 | 66 | - | - | - | - | - | - | - | - | - | - | - | - | - | - | - | - | - | - |
| 蜗轮蜗杆传动 Worm Gear Operated | H | - | - | - | 244 | 309 | 361 | 412 | 475 | 502 | 533 | 636 | 675 | 759 | 836 | 915 | 987 | 1212 | 1460 | 1600 | 1760 | 1845 |
| | W | - | - | - | 600 | 600 | 800 | 800 | 800 | 800 | 800 | 800 | 800 | 800 | 800 | 800 | 800 | 800 | 1000 | 1000 | 1000 | 1000 |
| | kg | - | - | - | 180 | 270 | 500 | 780 | 1100 | 1200 | 1600 | 2160 | 2700 | 5000 | 7000 | 9800 | 14000 | 19000 | 22000 | 32000 | 49000 | 56000 |
| 气动 Air-Operating | H | 269 | - | 519 | 636 | 728 | 839 | 1014 | 1120 | 1224 | 1374 | - | 1490 | 1615 | 1760 | - | - | - | - | - | - | - |
| | H1 | 209 | - | 295 | 479 | 519 | 595 | 770 | 810 | 1004 | 1154 | - | 1210 | 1335 | 1410 | - | - | - | - | - | - | - |
| | kg | 60 | - | 112 | 196 | 380 | 585 | 760 | 1190 | 1690 | 2250 | - | 3200 | 4520 | 6350 | - | - | - | - | - | - | - |
| 电动 Electric Driving | H | - | - | - | 527 | 533 | 653 | 652 | 801 | 784 | 809 | 948 | 1038 | 1253 | 1473 | 1387 | 1512 | 2114 | 2254 | 2424 | 2524 | |
| | H1 | - | - | - | 309 | 361 | 412 | 475 | 502 | 533 | 636 | 675 | 765 | 960 | 1150 | 987 | 1212 | 1390 | 1530 | 1700 | 1800 | |
| | kg | - | - | - | 200 | 200 | 280 | 280 | 280 | 280 | 305 | 305 | 305 | 400 | 400 | 600 | 600 | 600 | 600 | 600 | 600 | 600 |



Forged steel trunnion type ball valve

固定式锻钢球阀

W(K)Q(3、6、7、8、9)4(6)7F(Y、N、P)

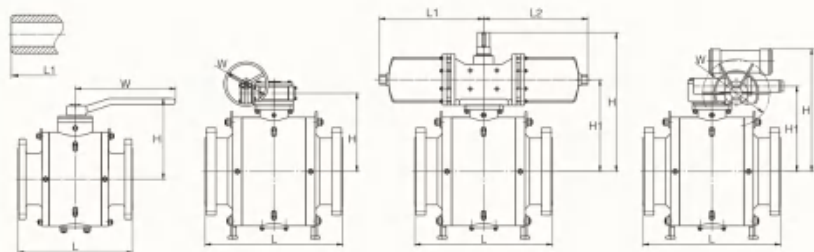

尺寸及重量 Size and weight

PN15.0MPa CLASS 900

| DN | mm | 50 | 85 | 100 | 150 | 200 | 250 | 300 | 350 | 400 | 450 | 500 | 600 | 750 | 900 | 1000 | 1200 | | |
|--|------------|-----|-------|------|-----------------|-----------------|-----------------|----------------|----------------|----------------|----------------|----------------|----------------|----------------|----------------|----------------|----------------|----------------|-------|
| NPS | in | 2 | 2 1/2 | 3 | 4 | 6 | 8 | 10 | 12 | 14 | 16 | 18 | 20 | 24 | 30 | 32 | 36 | 40 | 48 |
| 法兰 Flange | L | 368 | 419 | 381 | 457 | 610 | 737 | 838 | 965 | 1029 | 1130 | 1219 | 1321 | 1549 | 1780 | 2050 | 2050 | 2180 | 2600 |
| 对焊 Butt Welding | L1 | 368 | 419 | 381 | 457 | 610 | 737 | 838 | 965 | 1029 | 1130 | 1219 | 1321 | 1549 | 1700 | 1780 | 1960 | 2100 | 2376 |
| 手动 Hand- Operated | H | 148 | 191 | 216 | - | - | - | - | - | - | - | - | - | - | - | - | - | - | - |
| | W | 650 | 650 | 650 | - | - | - | - | - | - | - | - | - | - | - | - | - | - | - |
| | kg | 50 | 55 | 80 | - | - | - | - | - | - | - | - | - | - | - | - | - | - | - |
| 蜗轮蜗 杆传动 Worm Gear Operated | H | - | - | - | 270 | 384 | 435 | 518 | 657 | 693 | 762 | 866 | 894 | 965 | 1160 | 1240 | 1310 | 1420 | 1530 |
| | W | - | - | - | 600 | 800 | 800 | 800 | 800 | 800 | 800 | 800 | 800 | 800 | 800 | 1000 | 1000 | 1000 | 1000 |
| | 型号 Type | - | - | - | B | - | C | D | D | DA | DB | DC | DD | DH | DI | DI | DK | DK | |
| | kg | - | - | - | 150 | 360 | 620 | 1100 | 1600 | 1850 | 2200 | 2800 | 4250 | 7000 | 12500 | 14500 | 18000 | 22000 | 32000 |
| 气动 Air- Operating | H | 519 | - | 728 | 842 | 1014 | 1120 | 1124 | 13747 | 1490 | 1615 | 1760 | 1760 | - | - | - | - | - | |
| | H1 | 295 | - | 519 | 595 | 770 | 815 | 1004 | 1154 | 1210 | 1335 | 1410 | 1410 | - | - | - | - | - | |
| | L1 | 287 | - | 378 | 530 | 530 | 680 | 1455 | 1455 | 1665 | 1665 | 1960 | 1960 | - | - | - | - | - | |
| | L2 | 287 | - | 378 | 530 | 530 | 680 | 1455 | 1455 | 1665 | 1665 | 1960 | 1960 | - | - | - | - | - | |
| 型号 Type | AW17 | - | AW17 | AW20 | AW20 | AW28 | C1-355 | C1-355 | C2-490 | C2-490 | C2-490 | C3-600 | - | - | - | - | - | | |
| kg | 80 | - | 145 | 225 | 380 | 700 | 1200 | 1750 | 1900 | 2300 | 2900 | 4350 | 8100 | - | - | - | - | | |
| 电动 Electric Driving | H | - | - | - | 418 | 625 | 612 | 817 | 908 | 866 | 1035 | 1139 | 1167 | 1279 | 1854 | 1934 | 2004 | 2114 | 2224 |
| | H1 | - | - | - | 270 | 384 | 435 | 518 | 657 | 693 | 762 | 866 | 894 | 956 | 1130 | 1210 | 1280 | 1390 | 1500 |
| | W | - | - | - | 200 | 280 | 280 | 280 | 305 | 305 | 305 | 400 | 400 | 600 | 600 | 600 | 600 | 600 | 600 |
| | 型号 Type | - | - | - | SMC-04 +H1BC | SMC-00 +H1BC | SMC-00 +H1BC | SMC-0 +H1BC | SMC-0 +H1BC | SMC-1 +H1BC | SMC-3 +H1BC | SMC-3 +H1BC | SMC-4 +H1BC | SMC-5 +H1BC | SMC-5 +H1BC | SMC-5 +H1BC | SMC-5 +H1BC | SMC-5 +H1BC | |
| kg | - | - | - | 240 | 390 | 710 | 1300 | 1780 | 2000 | 2410 | 3110 | 4420 | 8250 | 13200 | 16000 | 19500 | 23500 | 33100 | |



Forged steel trunnion type ball valve

固定式锻钢球阀

W(K)Q(3、6、7、8、9)4(6)7F(Y、N、P)

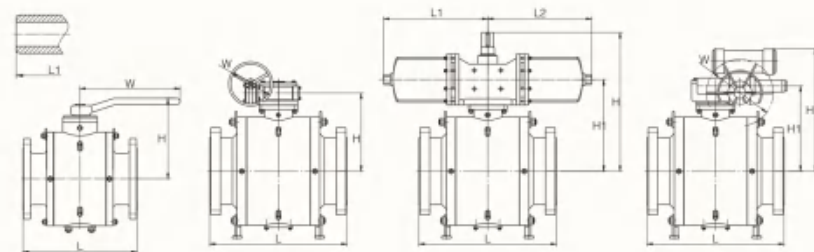

尺寸及重量 Size and weight

PN25.0MPa CLASS 1500

| DN | mm | 50 | 85 | 100 | 150 | 200 | 250 | 300 | 350 | 400 | 450 | 500 | 600 | |
|--|------------|------|-------|-----------------|-----------------|-----------------|-----------------|----------------|----------------|----------------|----------------|----------------|----------------|----------------|
| NPS | in | 2 | 2 1/2 | 3 | 4 | 6 | 8 | 10 | 12 | 14 | 16 | 18 | 20 | 24 |
| 法兰 Flange | L | 368 | 419 | 470 | 546 | 705 | 832 | 991 | 1130 | 1257 | 1384 | 1537 | 1664 | 2043 |
| 对焊 Butt Welding | L1 | 368 | 419 | 470 | 546 | 705 | 832 | 991 | 1130 | 1257 | 1384 | 1537 | 1664 | 2043 |
| 手动 Hand- Operated | H | 175 | 191 | 216 | - | - | - | - | - | - | - | - | - | - |
| | W | 650 | 650 | 750 | - | - | - | - | - | - | - | - | - | - |
| | kg | 60 | 70 | 85 | - | - | - | - | - | - | - | - | - | - |
| 蜗轮蜗 杆传动 Worm Gear Operated | H | 175 | 91 | 216 | 247 | 329 | 492 | 428 | 640 | 670 | 700 | 775 | 830 | 952 |
| | W | 400 | 400 | 600 | 600 | 800 | 800 | 800 | 800 | 800 | 800 | 800 | 800 | 800 |
| | 型号 Type | A | A | B | B | C | D | D | DA | DB | DC | DD | DH | DH |
| | kg | 65 | 82 | 100 | 210 | 500 | 850 | 1600 | 2300 | 2950 | 4000 | 5000 | 5600 | 2200 |
| 气动 Air- Operating | H | 519 | 728 | 842 | 1014 | 1120 | 1124 | 1374 | 1490 | 1615 | 1760 | 1760 | 1760 | - |
| | H1 | 295 | 519 | 595 | 770 | 815 | 1004 | 1154 | 1210 | 1335 | 1410 | 1410 | 1410 | - |
| | L1 | 287 | 378 | 530 | 530 | 680 | 1455 | 1455 | 1665 | 1665 | 1960 | 1960 | 1960 | - |
| | L2 | 287 | 378 | 530 | 530 | 680 | 1455 | 1455 | 1665 | 1665 | 1960 | 1960 | 1960 | - |
| 型号 Type | AW17 | AW17 | AW17 | AW20 | AW28 | AW28 | C1-355 | C1-355 | C2-490 | C2-490 | C2-429 | C3-600 | - | |
| kg | 90 | 135 | 155 | 280 | 510 | 900 | 1710 | 2350 | 3100 | 4410 | 5100 | 6100 | - | |
| 电动 Electric Driving | H | - | - | 388 | 488 | 506 | 591 | 679 | 813 | 943 | 973 | 1048 | 1153 | - |
| | H1 | - | - | 216 | 247 | 329 | 392 | 428 | 640 | 670 | 700 | 775 | 830 | - |
| | W | - | - | 200 | 280 | 280 | 280 | 305 | 305 | 305 | 400 | 400 | 600 | - |
| | 型号 Type | - | - | SMC-04 +H1BC | SMC-04 +H1BC | SMC-00 +H1BC | SMC-00 +H1BC | SMC-0 +H1BC | SMC-0 +H1BC | SMC-1 +H1BC | SMC-3 +H1BC | SMC-3 +H1BC | SMC-3 +H1BC | SMC-4 +H1BC |
| kg | - | - | 160 | 280 | 520 | 950 | 1800 | 2400 | 3300 | 4510 | 6200 | 7200 | - | |

Welded structure trunnion type ball valve

全焊接结构固定式球阀

W(K)Q(3、6、7、8、9)4(6)7F(Y、N、P)

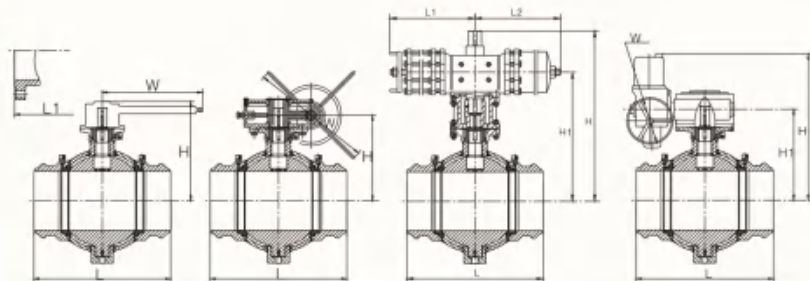

尺寸及重量 Size and weight

PN1.6MPa CLASS 150

| DN | mm | 50 | 65 | 80 | 100 | 125 | 150 | 200 | 250 | 300 | 350 | 400 | 450 | 500 | 600 | 700 | 800 | 900 | 1000 | 1050 | 1200 | 1400 | 1500 |
|----------------------------|------------|------|-------|------|------|------|--------|--------|--------|--------|--------|--------|--------|--------|--------------|--------------|--------|-------|-------|-------|-------|-------|-------|
| MPS | in | 2 | 2 1/2 | 3 | 4 | 5 | 6 | 8 | 10 | 12 | 14 | 16 | 18 | 20 | 24 | 28 | 32 | 36 | 40 | 42 | 48 | 56 | 60 |
| 对焊 Butt Welding | L | 216 | 241 | 283 | 305 | 381 | 457 | 521 | 599 | 635 | 762 | 838 | 914 | 991 | 1143 | 1346 | 1524 | 1727 | 1930 | 1829 | 2180 | 2300 | 2400 |
| 法兰 Flange | L1 | 178 | 191 | 203 | 229 | 356 | 394 | 457 | 533 | 610 | 686 | 762 | 864 | 914 | 1067 | 1245 | 1372 | 1524 | 1721 | 1689 | 2100 | 2250 | 2400 |
| 手动 Hand-Operated | H | 107 | 125 | 152 | 178 | 300 | 330 | - | - | - | - | - | - | - | - | - | - | - | - | - | - | - | - |
| | W | 230 | 350 | 400 | 490 | 700 | 750 | - | - | - | - | - | - | - | - | - | - | - | - | - | - | - | - |
| | kg | 23 | 42 | 50 | 65 | 70 | 82 | - | - | - | - | - | - | - | - | - | - | - | - | - | - | - | - |
| 蜗轮蜗杆 Worm Gear Operated | H | - | - | - | - | - | 337 | 385 | 414 | 447 | 510 | 538 | 585 | 665 | 730 | 930 | 990 | 1070 | 1260 | 1370 | 1480 | 1550 | |
| | W | - | - | - | - | - | 600 | 600 | 800 | 800 | 800 | 800 | 800 | 800 | 800 | 800 | 800 | 800 | 800 | 800 | 800 | 800 | 800 |
| | 型号 Type | - | - | - | - | - | B | B | C | C | D | D | D | DA | DA | DB | DB | DC | DC | DD | DD | DH | DH |
| kg | - | - | - | - | - | 133 | 206 | 312 | 413 | 577 | 780 | 1028 | 1706 | 2534 | 3644 | 4966 | 6800 | 8500 | 11173 | 12300 | 15800 | | |
| 气动 Air-Operating | H | 269 | 379 | 389 | 479 | 552 | 666 | 804 | 839 | 972 | 1127 | 1459 | 1529 | 1599 | 1645 | 1160 | 1460 | 1510 | 1610 | - | - | - | - |
| | H1 | 174 | 248 | 258 | 322 | 395 | 457 | 595 | 630 | 728 | 883 | 1154 | 1224 | 1294 | 915 | 930 | 1100 | 1150 | 1250 | - | - | - | - |
| | L1 | 89 | 148 | 148 | 287 | 287 | 378 | 378 | 378 | 530 | 530 | 680 | 680 | 680 | 1455 | 1455 | 1665 | 1665 | 1960 | - | - | - | - |
| | L2 | 181 | 257 | 257 | 287 | 287 | 378 | 378 | 378 | 530 | 530 | 680 | 680 | 680 | 1455 | 1455 | 1665 | 1665 | 1960 | - | - | - | - |
| | 型号 Type | AG09 | AG13 | AG13 | AW13 | AW13 | AW17 | AW17 | AW20 | AW20 | AW28 | AW28 | AW28 | AW28 | C1-355C1-355 | C2-490C2-490 | C3-600 | - | - | - | - | - | - |
| kg | 40 | 50 | 72 | 80 | 110 | 130 | 180 | 300 | 350 | 450 | 610 | 820 | 1100 | 1900 | 2600 | 4000 | 5100 | 7200 | - | - | - | - | |
| 电动 Electric Driving | H | - | - | - | - | - | 435 | 480 | 532 | 600 | 610 | 670 | 760 | 763 | 903 | 982 | 1108 | 1445 | 1655 | 1954 | 2064 | 2174 | 2244 |
| | H1 | - | - | - | - | - | 215 | 262 | 315 | 320 | 360 | 420 | 510 | 590 | 630 | 725 | 835 | 880 | 970 | 1230 | 1340 | 1490 | 1520 |
| | W | - | - | - | - | - | 200 | 200 | 200 | 280 | 280 | 280 | 305 | 305 | 305 | 400 | 400 | 460 | 460 | 600 | 600 | 600 | 600 |
| | 型号 Type | - | - | - | - | - | SNC-04 | SNC-04 | SNC-04 | SNC-04 | SNC-03 | SNC-03 | SNC-03 | SNC-03 | SNC-03 | SNC-03 | SNC-1 | SNC-2 | SNC-3 | SNC-3 | SNC-4 | SNC-4 | SNC-4 |
| | kg | - | - | - | - | - | 145 | 196 | 310 | 360 | 475 | 625 | 880 | 1200 | 2100 | 2750 | 4230 | 6000 | 7800 | 9000 | 12500 | 14000 | 17000 |

Welded structure trunnion type ball valve

全焊接结构固定式球阀

W(K)Q(3、6、7、8、9)4(6)7F(Y、N、P)

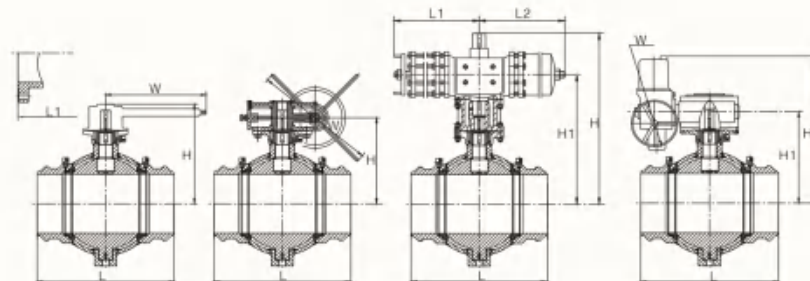

尺寸及重量 Size and weight

PN2.5、4.0MPa CLASS 300

| DN | mm | 50 | 65 | 80 | 100 | 125 | 150 | 200 | 250 | 300 | 350 | 400 | 450 | 500 | 600 | 700 | 800 | 900 | 1000 | 1050 | 1200 | 1400 | 1500 |
|----------------------------|------------|------|-------|------|------|------|--------|--------|--------|--------|--------|--------|--------|--------|--------|--------|--------|--------|--------|--------|-------|-------|-------|
| MPS | in | 2 | 2 1/2 | 3 | 4 | 5 | 6 | 8 | 10 | 12 | 14 | 16 | 18 | 20 | 24 | 28 | 32 | 36 | 40 | 42 | 48 | 56 | 60 |
| 对焊 Butt Welding | L | 216 | 241 | 283 | 305 | 381 | 457 | 521 | 599 | 635 | 762 | 838 | 914 | 991 | 1143 | 1346 | 1524 | 1727 | 2063 | 2050 | 2180 | 2300 | 2400 |
| 法兰 Flange | L1 | 216 | 241 | 283 | 305 | 381 | 403 | 502 | 568 | 648 | 762 | 838 | 914 | 991 | 1143 | 1346 | 1524 | 1727 | 2063 | 1960 | 2020 | 2250 | 2400 |
| 手动 Hand-Operated | H | 107 | 125 | 152 | 178 | 300 | 330 | - | - | - | - | - | - | - | - | - | - | - | - | - | - | - | - |
| | W | 230 | 400 | 400 | 600 | 750 | 800 | - | - | - | - | - | - | - | - | - | - | - | - | - | - | - | - |
| | kg | 32 | 48 | 65 | 75 | 82 | 91 | - | - | - | - | - | - | - | - | - | - | - | - | - | - | - | - |
| 蜗轮蜗杆 Worm Gear Operated | H | - | - | - | - | - | - | 278 | 375 | 460 | 465 | 510 | 538 | 660 | 830 | 880 | 930 | 990 | 1070 | 1260 | 1370 | 1480 | 1550 |
| | W | - | - | - | - | - | - | 600 | 600 | 800 | 800 | 800 | 800 | 800 | 800 | 800 | 800 | 800 | 800 | 800 | 800 | 800 | 800 |
| | 型号 Type | - | - | - | - | - | - | B | B | C | C | D | D | DA | DB | DC | DC | DD | DD | DD | DH | DH | DH |
| kg | - | - | - | - | - | - | 152 | 242 | 376 | 489 | 708 | 950 | 1247 | 2066 | 3101 | 4374 | 6050 | 8185 | 9500 | 13413 | 14200 | 17500 | |
| 气动 Air-Operating | H | 269 | 379 | 452 | 579 | 595 | 595 | 736 | 942 | 994 | 1188 | 1280 | 1480 | 1554 | 1380 | 1430 | 1599 | 1790 | 1850 | - | - | - | - |
| | H1 | 209 | 248 | 295 | 322 | 386 | 386 | 527 | 698 | 750 | 883 | 975 | 1080 | 1154 | 930 | 980 | 1149 | 1190 | 1250 | - | - | - | - |
| | L1 | 148 | 148 | 287 | 287 | 378 | 378 | 378 | 530 | 530 | 680 | 680 | 680 | 1455 | 1455 | 1665 | 1665 | 1960 | 1960 | - | - | - | - |
| | L2 | 181 | 257 | 287 | 287 | 378 | 378 | 378 | 530 | 530 | 680 | 680 | 680 | 1455 | 1455 | 1665 | 1665 | 1960 | 1960 | - | - | - | - |
| | 型号 Type | AG13 | AG13 | AW13 | AW13 | AW17 | AW17 | AW17 | AW20 | AW20 | AW28 | AW28 | C1-355 | C1-355 | C2-490 | C2-490 | C3-600 | C3-600 | C3-600 | C3-600 | - | - | - |
| kg | 49 | 64 | 70 | 82 | 112 | 145 | 220 | 310 | 395 | 510 | 752 | 1000 | 1320 | 2200 | 3200 | 4520 | 6500 | 9100 | - | - | - | - | |
| 电动 Electric Driving | H | - | - | - | - | - | 434 | 480 | 532 | 641 | 611 | 670 | 761 | 763 | 903 | 998 | 1108 | 1565 | 1655 | 2105 | 2245 | 2395 | 2670 |
| | H1 | - | - | - | - | - | 217 | 263 | 315 | 360 | 360 | 420 | 510 | 590 | 670 | 725 | 835 | 880 | 970 | 1420 | 1560 | 1710 | 1785 |
| | W | - | - | - | - | - | 200 | 200 | 200 | 280 | 280 | 280 | 305 | 305 | 305 | 400 | 460 | 460 | 600 | 600 | 600 | 600 | 600 |
| | 型号 Type | - | - | - | - | - | SNC-04 | SNC-04 | SNC-04 | SNC-03 | SNC-03 | SNC-03 | SNC-03 | SNC-03 | SNC-03 | SNC-1 | SNC-2 | SNC-3 | SNC-3 | SNC-4 | SNC-4 | SNC-4 | SNC-4 |
| | kg | - | - | - | - | - | 170 | 290 | 330 | 415 | 525 | 780 | 1200 | 1380 | 2400 | 3500 | 4630 | 6850 | 10500 | 11000 | 14000 | 15200 | 18100 |

Welded structure trunnion type ball valve

全焊接结构固定式球阀

W(K)Q(3、6、7、8、9)4(6)7F(Y、N、P)

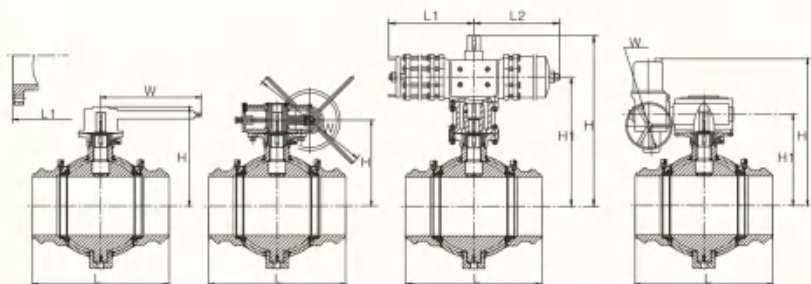

尺寸及重量 Size and weight

PN6.4MPa CLASS 400

| DN | mm | 50 | 65 | 80 | 100 | 150 | 200 | 250 | 300 | 350 | 400 | 450 | 500 | 600 | 700 | 800 | 900 | 1000 | 1050 | 1200 | 1400 | 1500 |
|----------------------------|----|-----|-------|-----|-----|-----|------|------|------|------|------|------|------|------|------|------|------|-------|-------|-------|-------|------|
| NPS | in | 2 | 2 1/2 | 3 | 4 | 6 | 8 | 10 | 12 | 14 | 16 | 18 | 20 | 24 | 28 | 32 | 36 | 40 | 42 | 48 | 56 | 60 |
| 对焊 Butt Welding | L | 292 | 330 | 356 | 406 | 495 | 597 | 673 | 762 | 826 | 902 | 978 | 1054 | 1232 | 1397 | 1651 | 1880 | 2300 | 2057 | 2400 | 2400 | 2700 |
| | L1 | 292 | 330 | 356 | 406 | 495 | 597 | 673 | 762 | 826 | 902 | 978 | 1054 | 1232 | 1397 | 1651 | 1880 | 2300 | 2050 | 2180 | 2300 | 2400 |
| 手动 Hand-Operated | H | 108 | 155 | 197 | - | - | - | - | - | - | - | - | - | - | - | - | - | - | - | - | - | - |
| | W | 230 | 400 | 400 | - | - | - | - | - | - | - | - | - | - | - | - | - | - | - | - | - | - |
| | kg | 38 | 52 | 72 | - | - | - | - | - | - | - | - | - | - | - | - | - | - | - | - | - | - |
| 蜗轮蜗杆 Worm Gear Operated | H | - | - | 115 | 180 | 254 | 325 | 392 | 390 | 455 | 590 | 630 | 759 | 836 | 915 | 987 | 1212 | 1260 | 1370 | 1480 | 1550 | |
| | W | - | - | 600 | 600 | 800 | 800 | 800 | 800 | 800 | 800 | 800 | 800 | 800 | 800 | 800 | 800 | 1000 | 1000 | 1000 | 1000 | |
| | kg | - | - | 88 | 105 | 169 | 260 | 420 | 525 | 820 | 1120 | 1400 | 2400 | 3400 | 4800 | 7200 | 9600 | 11500 | 16000 | 18000 | 22000 | |
| 气动 Air-Operating | H | 269 | 519 | 636 | 728 | 839 | 1014 | 1120 | 1225 | 1675 | - | 1675 | 1945 | 1945 | - | - | - | - | - | - | - | |
| | H1 | 209 | 295 | 322 | 366 | 527 | 698 | 750 | 883 | 1080 | - | 1080 | 980 | 980 | - | - | - | - | - | - | - | |
| | L1 | 148 | 287 | 287 | 378 | 378 | 530 | 530 | 680 | 680 | - | 680 | 1665 | 1665 | - | - | - | - | - | - | - | |
| 电动 Electric Driving | H | - | - | - | 434 | 480 | 432 | 640 | 611 | 671 | 761 | 763 | 903 | 998 | 1108 | 1260 | 1505 | 1954 | 2064 | 2174 | 2244 | |
| | H1 | - | - | - | 217 | 262 | 360 | 400 | 434 | 472 | 510 | 590 | 630 | 725 | 835 | 960 | 1205 | 1230 | 1340 | 1450 | 1520 | |
| | kg | - | - | - | 172 | 235 | 340 | 465 | 600 | 850 | 1200 | 1500 | 2600 | 4200 | 5200 | 7900 | 9500 | 12500 | 17500 | 19000 | 23000 | |

Welded structure trunnion type ball valve

全焊接结构固定式球阀

W(K)Q(3、6、7、8、9)4(6)7F(Y、N、P)

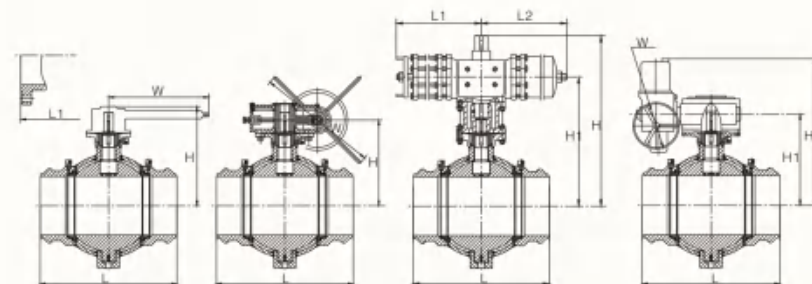

尺寸及重量 Size and weight

PN10.0MPa CLASS 600

| DN | mm | 50 | 65 | 80 | 100 | 150 | 200 | 250 | 300 | 350 | 400 | 450 | 500 | 600 | 700 | 800 | 900 | 1000 | 1050 | 1200 | 1400 | 1500 |
|----------------------------|----|-----|-------|-----|-----|-----|------|------|------|------|------|------|------|------|------|------|-------|-------|-------|-------|-------|-------|
| NPS | in | 2 | 2 1/2 | 3 | 4 | 6 | 8 | 10 | 12 | 14 | 16 | 18 | 20 | 24 | 28 | 32 | 36 | 40 | 42 | 48 | 56 | 60 |
| 对焊 Butt Welding | L | 292 | 330 | 356 | 432 | 559 | 660 | 787 | 838 | 889 | 991 | 1092 | 1194 | 1397 | 1549 | 1778 | 2083 | 2337 | 2100 | 2400 | 2400 | 2700 |
| | L1 | 292 | 330 | 356 | 432 | 559 | 660 | 787 | 838 | 889 | 991 | 1092 | 1194 | 1397 | 1549 | 1778 | 2083 | 2337 | 2050 | 2180 | 2300 | 2400 |
| 手动 Hand-Operated | H | 108 | 155 | 197 | - | - | - | - | - | - | - | - | - | - | - | - | - | - | - | - | - | |
| | W | 500 | 650 | 650 | - | - | - | - | - | - | - | - | - | - | - | - | - | - | - | - | - | |
| | kg | 45 | 60 | 80 | - | - | - | - | - | - | - | - | - | - | - | - | - | - | - | - | - | |
| 蜗轮蜗杆 Worm Gear Operated | H | - | - | - | 115 | 180 | 254 | 325 | 392 | 390 | 455 | 590 | 630 | 830 | 960 | 1030 | 1171 | 1250 | 1260 | 1370 | 1480 | 1550 |
| | W | - | - | - | 600 | 600 | 800 | 800 | 800 | 800 | 800 | 800 | 800 | 800 | 800 | 800 | 800 | 800 | 800 | 1000 | 1000 | 1000 |
| | kg | - | - | - | 95 | 116 | 189 | 296 | 466 | 597 | 860 | 1154 | 1568 | 2613 | 3841 | 5508 | 7597 | 10370 | 12500 | 17136 | 21000 | 23400 |
| 气动 Air-Operating | H | 209 | 519 | 636 | 728 | 839 | 1014 | 1120 | 1224 | 1374 | - | 1490 | 1615 | 1760 | - | - | - | - | - | - | | |
| | H1 | 209 | 295 | 479 | 519 | 595 | 770 | 815 | 1004 | 1154 | - | 1210 | 1335 | 1410 | - | - | - | - | - | - | | |
| | L1 | 148 | 287 | 287 | 378 | 530 | 530 | 680 | 1455 | 1455 | - | 1665 | 1665 | 1960 | - | - | - | - | - | | | |
| 电动 Electric Driving | H | - | - | - | 480 | 532 | 641 | 651 | 670 | 761 | 783 | 943 | 998 | 1108 | 1238 | 1350 | 1400 | 1954 | 2064 | 2174 | 2244 | |
| | H1 | - | - | - | 262 | 360 | 400 | 474 | 472 | 510 | 610 | 670 | 725 | 835 | 915 | 1050 | 1100 | 1230 | 1340 | 1450 | 1520 | |
| | kg | - | - | - | 175 | 240 | 350 | 495 | 625 | 920 | 1200 | 1820 | 2500 | 4350 | 5800 | 8200 | 11200 | 14100 | 19000 | 23000 | 24000 | |

Welded structure trunnion type ball valve

全焊接结构固定式球阀

W(K)Q(3、6、7、8、9)4(6)7F(Y、N、P)

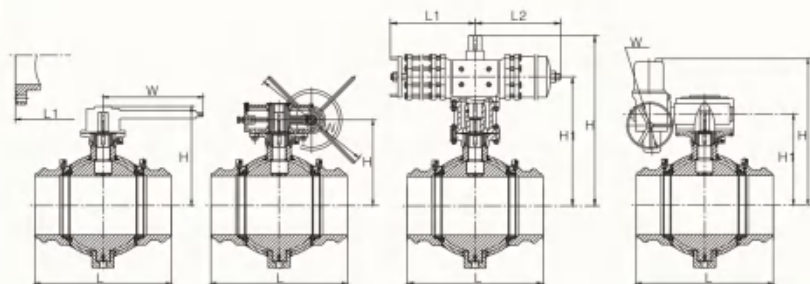

尺寸及重量 Size and weight

PN15.0MPa CLASS 900

| DN | mm | 50 | 65 | 80 | 100 | 150 | 200 | 250 | 300 | 350 | 400 | 450 | 500 | 600 | 750 | 800 | 900 | 1000 | 1200 |
|----------------------------|----|-----|-------|-----|-----|------|------|------|------|------|------|------|------|------|------|------|-------|-------|-------|
| NPS | in | 2 | 2 1/2 | 3 | 4 | 6 | 8 | 10 | 12 | 14 | 16 | 18 | 20 | 24 | 30 | 32 | 36 | 40 | 48 |
| 对焊 Butt Welding | L | 368 | 419 | 381 | 457 | 610 | 737 | 838 | 965 | 1029 | 1130 | 1219 | 1321 | 1549 | 1780 | 2050 | 2050 | 2180 | 2600 |
| 法兰 Flange | L1 | 368 | 419 | 381 | 457 | 610 | 737 | 838 | 965 | 1029 | 1130 | 1219 | 1321 | 1549 | 1700 | 1780 | 1960 | 2100 | 2376 |
| 手动 Hand-Operated | H | 217 | 241 | 259 | - | - | - | - | - | - | - | - | - | - | - | - | - | - | - |
| | W | 650 | 690 | 690 | - | - | - | - | - | - | - | - | - | - | - | - | - | - | - |
| | kg | 58 | 76 | 96 | - | - | - | - | - | - | - | - | - | - | - | - | - | - | - |
| 蜗轮蜗杆 Worm Gear Operated | H | - | - | - | 177 | 244 | 274 | 382 | 452 | 515 | 602 | 706 | 714 | 736 | 1050 | 1090 | 1150 | 1230 | 1350 |
| | W | - | - | - | 600 | 800 | 800 | 800 | 800 | 800 | 800 | 800 | 800 | 800 | 800 | 1000 | 1000 | 1000 | 1000 |
| | kg | - | - | - | 115 | 125 | 225 | 377 | 559 | 776 | 1124 | 1503 | 2049 | 3351 | 6008 | 7147 | 9908 | 11500 | 19000 |
| 气动 Air-Operating | H | 519 | - | 728 | 842 | 1014 | 1120 | 1224 | 1374 | 1490 | 1615 | 1760 | 1760 | - | - | - | - | - | - |
| | H1 | 295 | - | 519 | 595 | 770 | 815 | 1004 | 1154 | 1210 | 1335 | 1430 | 1410 | - | - | - | - | - | - |
| | L1 | 287 | - | 378 | 530 | 530 | 680 | 1455 | 1455 | 1665 | 1665 | 1960 | 1960 | - | - | - | - | - | - |
| 电动 Electric Driving | H | - | - | - | 480 | 641 | 651 | 711 | 811 | 783 | 963 | 1058 | 1148 | 1238 | 1744 | 1784 | 1844 | 1924 | 2044 |
| | H1 | - | - | - | 252 | 400 | 474 | 512 | 550 | 610 | 690 | 785 | 875 | 915 | 1020 | 1060 | 1120 | 1200 | 1320 |
| | kg | - | - | - | 128 | 175 | 265 | 395 | 635 | 812 | 1320 | 1750 | 2350 | 3560 | 4200 | 8100 | 11800 | 12500 | 20000 |

Welded structure trunnion type ball valve

全焊接结构固定式球阀

W(K)Q(3、6、7、8、9)4(6)7F(Y、N、P)

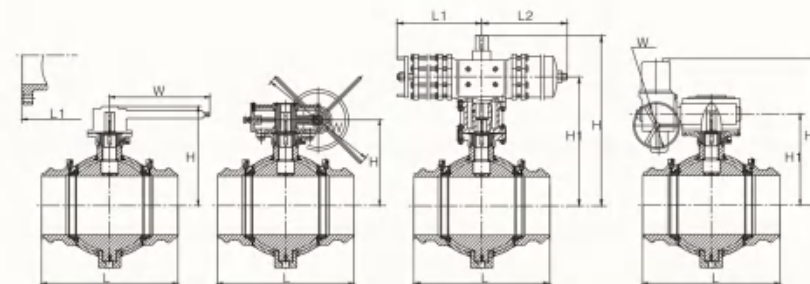

尺寸及重量 Size and weight

PN25.0MPa CLASS 1500

| DN | mm | 50 | 65 | 80 | 100 | 150 | 200 | 250 | 300 | 350 | 400 | 450 | 500 | 600 |
|----------------------------|----|-----|-------|-----|------|------|------|------|------|------|------|------|------|------|
| NPS | in | 2 | 2 1/2 | 3 | 4 | 6 | 8 | 10 | 12 | 14 | 16 | 18 | 20 | 24 |
| 对焊 Butt Welding | L | 368 | 419 | 470 | 546 | 705 | 832 | 991 | 1130 | 1257 | 1384 | 1537 | 1664 | 2043 |
| 法兰 Flange | L1 | 368 | 419 | 470 | 546 | 705 | 832 | 991 | 1130 | 1257 | 1384 | 1537 | 1664 | 2043 |
| 手动 Hand-Operated | H | 217 | 241 | 259 | - | - | - | - | - | - | - | - | - | - |
| | W | 650 | 690 | 650 | - | - | - | - | - | - | - | - | - | - |
| | kg | 75 | 82 | 105 | - | - | - | - | - | - | - | - | - | - |
| 蜗轮蜗杆 Worm Gear Operated | H | 137 | 161 | 169 | 177 | 244 | 355 | 458 | 576 | 601 | 671 | 740 | 770 | 860 |
| | W | 600 | 600 | 600 | 600 | 800 | 800 | 800 | 800 | 800 | 800 | 800 | 800 | 800 |
| | kg | 85 | 96 | 115 | 125 | 145 | 240 | 395 | 610 | 620 | 1250 | 1680 | 2400 | 3580 |
| 气动 Air-Operating | H | 519 | 728 | 842 | 1014 | 1120 | 1224 | 1374 | 1490 | 1615 | 1760 | 1760 | 1760 | - |
| | H1 | 295 | 519 | 595 | 770 | 815 | 1004 | 1154 | 1210 | 1335 | 1410 | 1410 | 1410 | - |
| | L1 | 287 | 378 | 530 | 530 | 680 | 1455 | 1455 | 1665 | 1665 | 1960 | 1960 | 1960 | - |
| 电动 Electric Driving | H | - | - | 542 | 641 | 651 | 711 | 801 | 823 | 965 | 1058 | 1168 | 1238 | - |
| | H1 | - | - | 370 | 400 | 474 | 512 | 550 | 650 | 690 | 785 | 895 | 915 | - |
| | kg | - | - | 142 | 160 | 196 | 320 | 452 | 850 | 910 | 1420 | 1960 | 2820 | - |